

# AUTOMATIC SCREW PRESENTER

---





## PRODUCTIVE SOLUTIONS

As an industrial process expert, we help you meet your challenges.

Productivity, safety, quality, industry 4.0 are themes on which we can offer you our expertise and our solutions. Whether in the field of assembly technology, machining or welding, our dedicated and specialised teams accompany your progress and recommend solutions and equipment to reach performance levels in line with your industrial strategy.



### Certified quality

From design to commissioning, DOGA guarantees the quality of this equipments and services according to ISO 9001: 2015 certification.

## 5 reasons to trust us



### Expertise

Our field experts propose you solutions adapted to your environment and specific needs.



### Innovation

By developing the products and the services of tomorrow, we offer you new perspectives or prospects.



### Performance

Our high added value solutions improve your performances and guarantee the final quality of the production.



### Commitment

Aware of your objectives, we commit ourselves to helping you to reach them.



### Reliability

Our organization which has been ISO 9001 certified since 1996, is the guarantee of your satisfaction.



ASSEMBLY TECHNOLOGY

As world class assembly technology player, we manufacture and market equipments and solutions for the assembly industry which contribute to the improvement of your manufacturing quality and productivity.

Our assembly, ergonomics and traceability solutions contribute to enhancing your productivity, controlling your process quality and meet the requirements of industry 4.0.

We offer products designed to last and high value-added services by relying on our teams know-how and expertise : design, production, installation, start-up, training and maintenance. We support you locally thanks to our worldwide presence through our subsidiaries and our specialized distribution network.



Contact us

@ international@dogas.com

+33 1 30 66 41 41

www.dogasassembly.com

# SUMMARY

## AUTOMATIC SCREW PRESENTER

Pages

▶ 4

**AUTOMATIC SCREW PRESENTERS WITH HORIZONTAL RAIL SYSTEM**

▶ 7

**AUTOMATIC SCREW PRESENTERS FOR MANUAL AND MAGNETIC PICKING UP OF THE SCREW**

- NJ serie
- NJL serie
- NJ serie
- NSB serie
- NSBI serie
- NSBC serie
- SS serie
- OM-26M serie

▶ 23

**AUTOMATIC SCREW PRESENTERS FOR SCREW PICKING UP BY VACUUM OR FOR USE IN AUTOMATIC STATIONS**

- NJR serie
- NJRL serie
- NSR serie
- NSRI serie
- OM-26R serie

▶ 33

**AUTOMATIC SCREW PRESENTERS FOR PICKING BY QUANTITY**

- FM-36 serie

▶ 35

**ACCESSORIES AND SERVICES**

- Additionnal vertical hoppers
- Additionnal rear hoppers
- Assembly sleeve supports and guides on feeder NJR / NSR
- Assembly and setting packages

▶ 42

**OUR SERVICES**

# AUTOMATIC SCREW PRESENTERS WITH HORIZONTAL RAIL SYSTEM

The gripping of small screws is delicate or even difficult.

- ▶ Screw dispensers present the screws to the user, which frees the operator's hand and facilitates the assembly of your application.
- ▶ They support a wide range of screw materials and shapes.
- ▶ They contribute to the efficiency of your production chain.
- ▶ The interchangeability of rails allows flexibility in your production lines.

## BENEFITS

### The gripping of small screws is delicate or even difficult

The horizontal rail allows the smooth presentation of many types of special screws including those with washers and short lengths under the head.



### Horizontal rail provides a stable assembly and an orderly distribution of screws

Unlike gravity-based mechanisms, this one uses vibration to transport screws in a horizontal rail, eliminating problems such as overlapping or clogging and allowing a stable presentation, even for screws with washers.

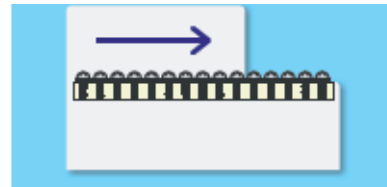

### Adapts to different screw diameters by simple rail replacement

The same model supports screw diameter by simply changing the rail. Some models support up to 8 screw diameters for a single unit.



## SCREW GRIPPING METHOD

### For manual and magnetic picking up of the screw

Favour manually operated dispensers ( NJ / NSB / NSBI / SS / OM-26M) because the screws are presented one by one at the bottom of a funnel-shaped blade guide where they are attached to the magnetic screwdriver bit without any effort.



### For screw picking up by vacuum or for use in automatic stations

Favour presenter ( NJR / NSR / NSRI / OM-26R)

The screws are presented one by one in a perfectly flat and unobstructed space for gripping at the end of the suction barrel or without any hindrance.

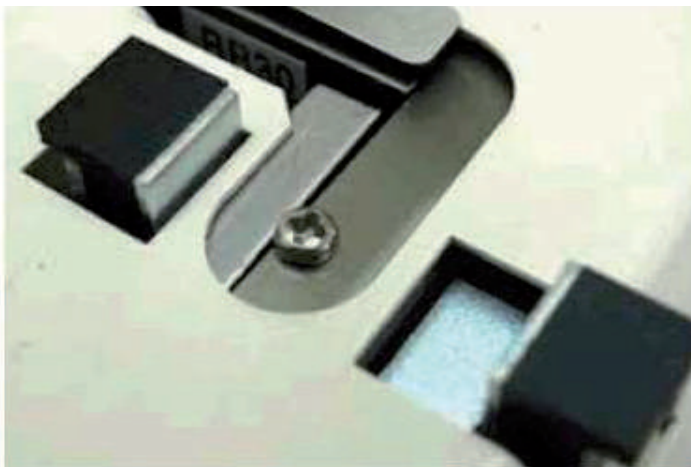

*Example of picking up with NJR / NSR / NSRI screw presenter series*



*Example of picking up with OM-26R screw presenter serie*

## LIST OF MODELS

To choose the model that corresponds to your application:

- 1 - Select the use (Use on manual, automatic or by quantity)
- 2 - Select the screw diameter of your application
- 3 - Select the model adapted to the length of your screw
- 4 - Select the model adapted to the material of your screw

Use	Serie	Model	Screw diameter												Supported screw maximum under-head length	Supported materials
			1,0	1,2	1,4	1,7	2,0	2,3	2,6	3,0	3,5	4,0	5,0	6,0		
Manual	NJ	NJ-23					■	■	■	■					18 mm	Ferrous/non-ferrous (irrespective of material)
		NJC-23					■	■	■	■					25 mm	
		NJL-23					■	■	■	■					18 mm	
		NJ-45									■	■	■		25 mm	
		NJC-45									■	■	■		20 mm	
		NJL-45									■	■	■		16 mm	
	NSB	NSB	■	■	■	■	■	■	■	■					20 mm	
		NSBC	■	■	■	■	■	■	■	■						
	NSBI	NSBI	■	■	■	■	■	■	■	■						
	SS	SS-12	■	■	■	■	■									
SS-23								■	■	■						
OM-26M	OM-26M					■	■	■	■	■	■	■	■	25 mm	Iron only Stainless : No (Uses magnet)	
Automatic	NJR	NJR-23					■	■	■	■					18 mm	Ferrous/non-ferrous (irrespective of material)
		NJRL-23					■	■	■	■					25 mm	
		NJR-45									■	■	■		18 mm	
		NJRL-45									■	■	■		25 mm	
	NSR	NSR	■	■	■	■	■	■	■	■					20 mm	
	NSRI	NSRI	■	■	■	■	■	■	■	■						
OM-26R	OM-26R					■	■	■	■	■	■	■	■	25 mm	Iron only Stainless : No (Uses magnet)	
Fixed quantity pick up	FM-36	FM-36								■	■	■	■	25 mm	Ferrous/non-ferrous (irrespective of material)	

# AUTOMATIC SCREW PRESENTERS FOR MANUAL AND MAGNETIC PICKING UP OF THE SCREW

## NJ serie

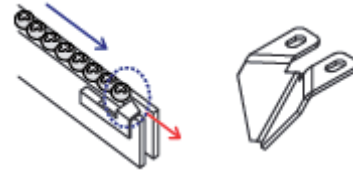

Take out type

- ▶ Accepts screw diameters up to 5 mm.
- ▶ Large autonomy the hopper has a capacity of 150cc. increased by using an additional hopper.

## Suitable screws

Model	Suitable Ø screw body (mm)	Suitable Ø screw head (mm)	Suitable H screw (mm)	Suitable washer Ø (mm)	Screw shaft length (mm)
NJ-2320	2 (1,8 to 2,1)	3 to 3,5	0,5 to 5,5	3 to 8	2,6 to 18
NJ-2323	2,3 (2,1 to 2,4)	3 to 4	0,5 to 5,5	3 to 8	2,9 to 18
NJ-2326	2,6 (2,4 to 2,7)	3,6 to 4,5	0,5 to 5,5	3 to 8	3,2 to 18
NJ-2330	3 (2,8 to 3,1)	4 to 5,5	0,5 to 5,5	4 to 8	3,6 to 18
NJ-4535	3,5 (3,3 to 3,7)	4,8 to 8	0,5 to 8	4,8 to 12	4,1 to 18
NJ-4540	4 (3,8 to 4,3)	5,4 to 8	0,5 to 8	5,4 to 12	4,6 to 18
NJ-4545	5 (4,8 to 5,1)	6,2 to 10	0,5 to 8	6,2 to 12	5,6 to 18

## Dispensers

Model	Code
Dispenser OHTAKE NJ-2320 screw 2.0 mm	<b>4-1510198</b>
Dispenser OHTAKE NJ-2323 screw 2.3 mm	<b>4-1510199</b>
Dispenser OHTAKE NJ-2326 screw 2.6 mm	<b>4-1510200</b>
Dispenser OHTAKE NJ-2330 screw 3.0 mm	<b>4-1510201</b>
Dispenser OHTAKE NJ-4535 screw 3.5 mm	<b>4-1510202</b>
Dispenser OHTAKE NJ-4540 screw 4.0 mm	<b>4-1510203</b>
Dispenser OHTAKE NJ-4550 screw 5.0 mm	<b>4-1510204</b>

## Additional rails

Model	Code
P/NJ23 & NJC 23 Rail R20 for screw 2.0 mm	<b>4-1510188</b>
P/NJ23 & NJC 23 Rail R23 for screw 2.3 mm	<b>4-1510189</b>
P/NJ23 & NJC 23 Rail R26 for screw 2.6 mm	<b>4-1510190</b>
P/NJ23 & NJC 23 Rail R30 for screw 3.0 mm	<b>4-1510191</b>
P/NJ45 & NJC 23 Rail R35 for screw 3.5 mm	<b>4-1510192</b>
P/NJ45 & NJC 23 Rail R40 for screw 4.0 mm	<b>4-1510193</b>
P/NJ45 & NJC 23 Rail R50 for screw 5.0 mm	<b>4-1510194</b>

## Features

Model	External dimensions	Screw capacity	Overload protection/recovery circuit	External signal line
NJ-2320	129,4 x 215 x 139 (H)	ENV 150 CC	Yes	Yes
NJ-2323			Yes	Yes
NJ-2326			Yes	Yes
NJ-2330			Yes	Yes
NJ-4535			Yes	Yes
NJ-4540			Yes	Yes
NJ-4545			Yes	Yes

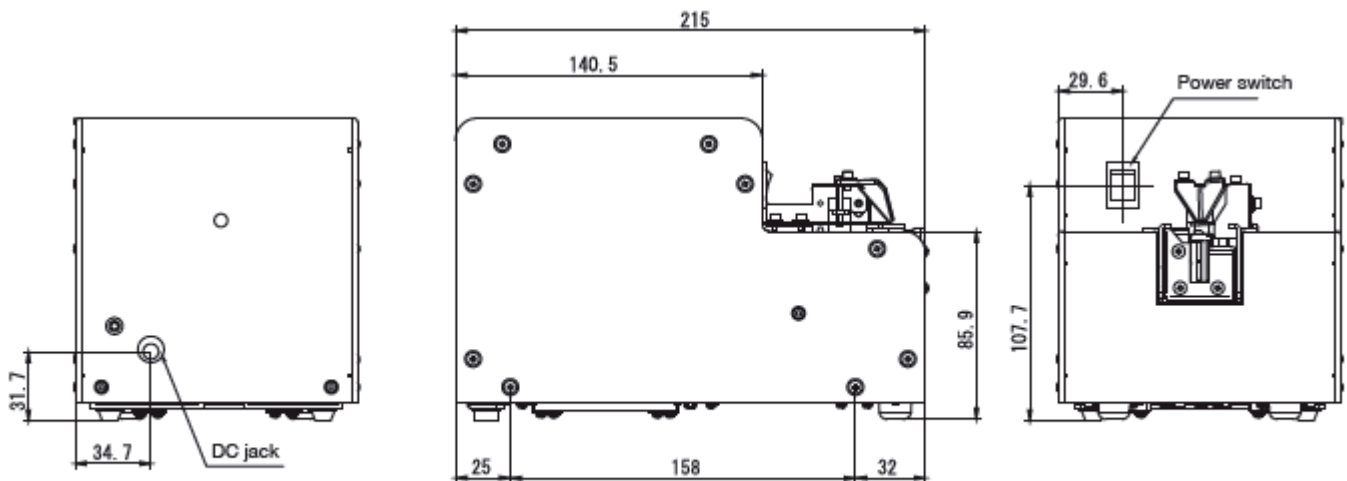
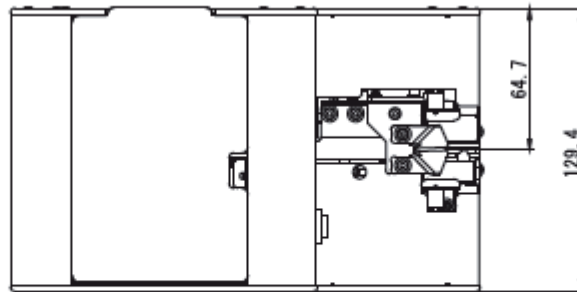



## NJL serie

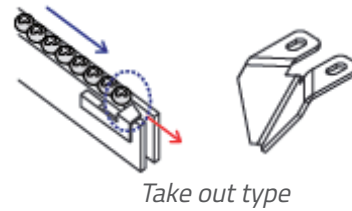

- ▶ Suitable for a longer range of screws than the NJ series, 25 mm instead of 18 mm.
- ▶ Suitable for a wide range of screw types.

### Suitable screws

Model	Suitable $\varnothing$ screw body (mm)	Suitable $\varnothing$ screw head (mm)	Suitable H screw (mm)	Suitable washer $\varnothing$ (mm)	Screw shaft length (mm)
NJL-2320	2 (1,8 to 2,1)	3 to 3,5	0,5 to 5,5	3 to 8	2,6 to 25
NJL-2323	2,3 (2,1 to 2,4)	3 to 4	0,5 to 5,5	3 to 8	2,9 to 25
NJL-2326	2,6 (2,4 to 2,7)	3,6 to 4,5	0,5 to 5,5	3 to 8	3,2 to 25
NJL-2330	3 (2,8 to 3,1)	4 to 5,5	0,5 to 5,5	4 to 8	3,6 to 25
NJL-4535	3,5 (3,3 to 3,7)	4,8 to 8	0,5 to 8	4,8 to 12	4,1 to 25
NJL-4540	4 (3,8 to 4,3)	5,4 to 8	0,5 to 8	5,4 to 12	4,6 to 25
NJL-4545	5 (4,8 to 5,1)	6,2 to 10	0,5 to 8	6,2 to 12	5,6 to 25

### Dispensers

Model	Code
Dispenser OHTAKE NJL-2320 screw 2.0 mm	<b>4-1510500</b>
Dispenser OHTAKE NJL-2323 screw 2.3 mm	<b>4-1510501</b>
Dispenser OHTAKE NJL-2326 screw 2.6 mm	<b>4-1510502</b>
Dispenser OHTAKE NJL-2330 screw 3.0 mm	<b>4-1510503</b>
Dispenser OHTAKE NJL-4535 screw 3.5 mm	<b>4-1510504</b>
Dispenser OHTAKE NJL-4540 screw 4.0 mm	<b>4-1510505</b>
Dispenser OHTAKE NJL-4550 screw 5.0 mm	<b>4-1510506</b>

### Additional rails

Model	Code
P/NJL-23 Rail RL20 for screw 2.0 mm	<b>4-1500020</b>
P/NJL-23 Rail RL23 for screw 2.3 mm	<b>4-1500024</b>
P/NJL-23 Rail RL26 for screw 2.6 mm	<b>4-1500026</b>
P/NJL-23 Rail RL30 for screw 3.0 mm	<b>4-1500027</b>
P/NJL-45 Rail RL35 for screw 3.5 mm	<b>4-1500028</b>
P/NJL-45 Rail RL40 for screw 4.0 mm	<b>4-1500029</b>
P/NJL-45 Rail RL50 for screw 5.0 mm	<b>4-1500031</b>

## Features

Model	External dimensions	Screw capacity	Overload protection/recovery circuit	External signal line
NJL-2320	129,4 x 215 x 139 (H)	ENV 150 CC	Yes	Yes
NJL-2323			Yes	Yes
NJL-2326			Yes	Yes
NJL-2330			Yes	Yes
NJL-4535			Yes	Yes
NJL-4540			Yes	Yes
NJL-4545			Yes	Yes

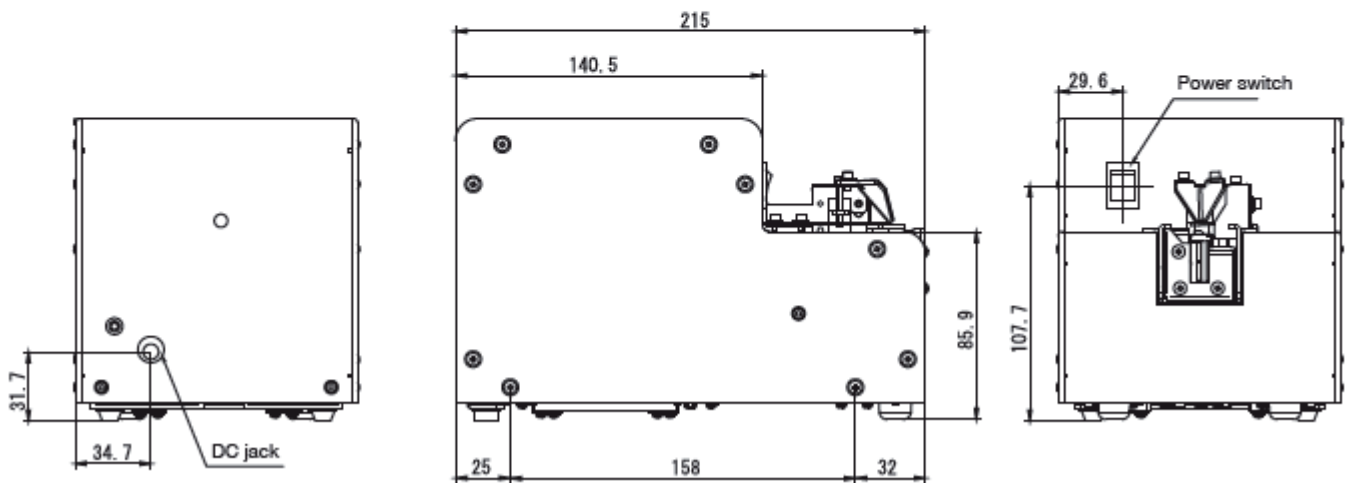
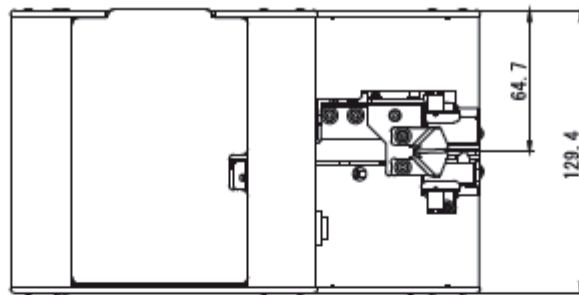

## NJC serie

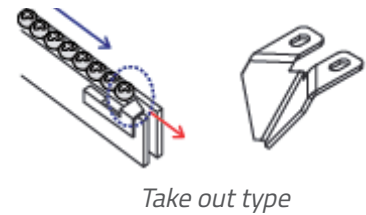

- ▶ Display of the number of screws distributed (counter per increment).
- ▶ Display of the number of screws remaining to be dispensed (counter by decrementing from a configurable setpoint).

### Suitable screws

Model	Suitable Ø screw body (mm)	Suitable Ø screw head (mm)	Suitable H screw (mm)	Suitable washer Ø (mm)	Screw shaft length (mm)
NJC-2320	2 (1,8 to 2,1)	3 to 3,5	0,5 to 5,5	3 to 8	2,6 to 18
NJC-2323	2,3 (2,1 to 2,4)	3 to 4	0,5 to 5,5	3 to 8	2,9 to 18
NJC-2326	2,6 (2,4 to 2,7)	3,6 to 4,5	0,5 to 5,5	3 to 8	3,2 to 18
NJC-2330	3 (2,8 to 3,1)	4 to 5,5	0,5 to 5,5	4 to 8	3,6 to 18
NJC-4535	3,5 (3,3 to 3,7)	4,8 to 8	0,5 to 8	4,8 to 12	4,1 to 18
NJC-4540	4 (3,8 to 4,3)	5,4 to 8	0,5 to 8	5,4 to 12	4,6 to 18
NJC-4545	5 (4,8 to 5,1)	6,2 to 10	0,5 to 8	6,2 to 12	5,6 to 18

### Dispensers

Model	Code
Dispenser OHTAKE NJC-2320 screw 2.0 mm	<b>4-1510109</b>
Dispenser OHTAKE NJC-2323 screw 2.3 mm	<b>4-1510110</b>
Dispenser OHTAKE NJC-2326 screw 2.6 mm	<b>4-1510111</b>
Dispenser OHTAKE NJC-2330 screw 3.0 mm	<b>4-1510112</b>
Dispenser OHTAKE NJC-4535 screw 3.5 mm	<b>4-1510113</b>
Dispenser OHTAKE NJC-4540 screw 4.0 mm	<b>4-1510114</b>
Dispenser OHTAKE NJC-4550 screw 5.0 mm	<b>4-1510115</b>

### Additional rails

Model	Code
P/NJ23 & NJC23 Rail R20 for screw 2.0 mm	<b>4-1510188</b>
P/NJ23 & NJC23 Rail R23 for screw 2.3 mm	<b>4-1510189</b>
P/NJ23 & NJC23 Rail R26 for screw 2.6 mm	<b>4-1510190</b>
P/NJ23 & NJC23 Rail R30 for screw 3.0 mm	<b>4-1510191</b>
P/NJ45 & NJC45 Rail R35 for screw 3.5 mm	<b>4-1510192</b>
P/NJ45 & NJC45 Rail R40 for screw 4.0 mm	<b>4-1510193</b>
P/NJ45 & NJC45 Rail R50 for screw 5.0 mm	<b>4-1510194</b>

## Features

Model	External dimensions	Screw capacity	Overload protection/recovery circuit	External signal line
NJC-2320	129,4 x 215 x 139 (H)	ENV 150 CC	Yes	Yes
NJC-2323			Yes	Yes
NJC-2326			Yes	Yes
NJC-2330			Yes	Yes
NJC-4535			Yes	Yes
NJC-4540			Yes	Yes
NJC-4545			Yes	Yes

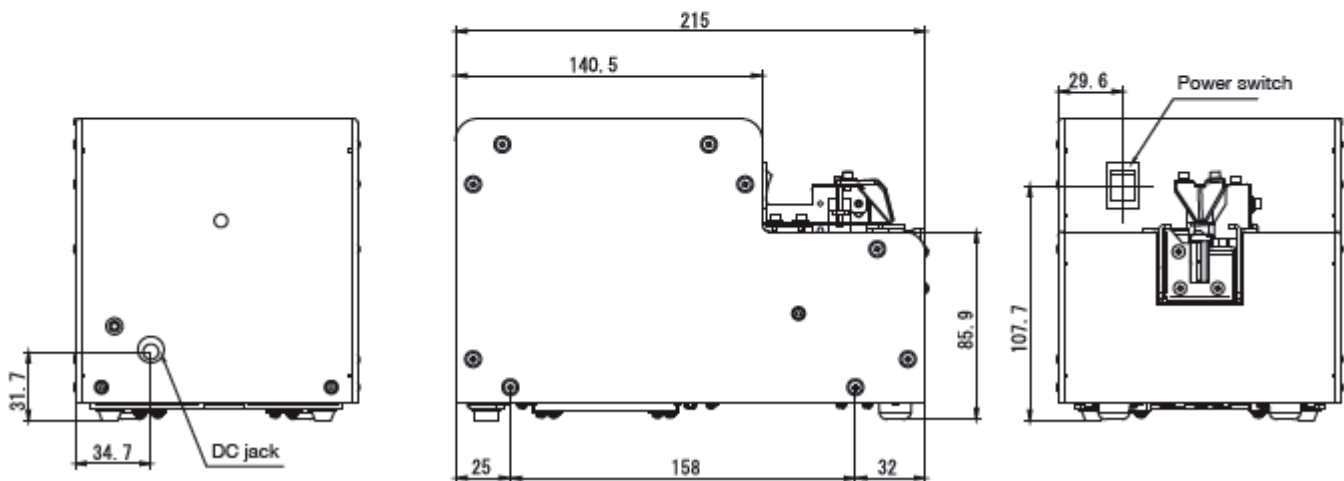
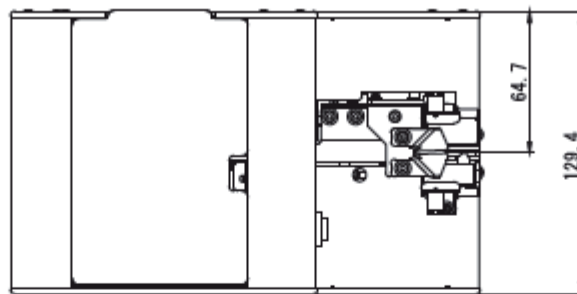

## NSB serie

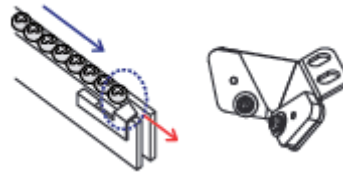

Take out type

- ▶ The exchange of rails makes it possible to adapt to different screw diameters with a single unit.
- ▶ Reduced size to save space on the workstation.

### Suitable screws

Model	Suitable $\varnothing$ screw body (mm)	Suitable $\varnothing$ screw head (mm)	Suitable H screw (mm)	Screw shaft length (mm)
NSB-10	1 (0,9 to 0,95)	1,2 to 4,5	0,35 to 1	1,6 to 10
NSB-12	1,2 (1,1 to 1,15)	1,4 to 4,5	0,35 to 1	1,8 to 10
NSB-14	1,4 (1,3 to 1,4)	1,7 to 4,5	0,35 to 1	2 to 10
NSB-17	1,7 (1,6 to 1,7)	2 to 4,5	0,35 to 1	2,3 to 10
NSB-20	2 (1,9 to 2,1)	2,4 to 6	0,35 to 4,5	2,6 to 20
NSB-23	2,3 (2,2 to 2,4)	2,7 to 6	0,35 to 4,5	2,9 to 20
NSB-26	2,6 (2,5 to 2,7)	3 to 6	0,35 to 4,5	3,2 to 20
NSB-30	3 (2,9 to 3,2)	3,5 to 6	0,35 to 4,5	3,6 to 20

### Dispensers

Model	Code	Model	Code
Dispenser OHTAKE NSB-10 screw 1.0 mm	<b>4-1510574</b>	P/NSB & NSBC Rail SR10 for screw 1.0 mm	<b>4-1510549</b>
Dispenser OHTAKE NSB-12 screw 1.2 mm	<b>4-1510575</b>	P/NSB & NSBC Rail SR12 for screw 1.2 mm	<b>4-1510550</b>
Dispenser OHTAKE NSB-14 screw 1.4 mm	<b>4-1510576</b>	P/NSB & NSBC Rail SR14 for screw 1.4 mm	<b>4-1510551</b>
Dispenser OHTAKE NSB-17 screw 1.7 mm	<b>4-1510577</b>	P/NSB & NSBC Rail SR17 for screw 1.7 mm	<b>4-1510552</b>
Dispenser OHTAKE NSB-20 screw 2.0 mm	<b>4-1510578</b>	P/NSB & NSBC Rail SR20 for screw 2.0 mm	<b>4-1510553</b>
Dispenser OHTAKE NSB-23 screw 2.3 mm	<b>4-1510579</b>	P/NSB & NSBC Rail SR23 for screw 2.3 mm	<b>4-1510554</b>
Dispenser OHTAKE NSB-26 screw 2.6 mm	<b>4-1510580</b>	P/NSB & NSBC Rail SR26 for screw 2.6 mm	<b>4-1510555</b>
Dispenser OHTAKE NSB-30 screw 3.0 mm	<b>4-1510581</b>	P/NSB & NSBC Rail SR30 for screw 3.0 mm	<b>4-1510556</b>

### Additional rails

## Features

Model	External dimensions	Screw capacity	Overload protection/recovery circuit	External signal line
NSB-10	123 x 181 x 144 (H)	ENV 80 CC	Yes	Yes
NSB-12			Yes	Yes
NSB-14			Yes	Yes
NSB-17			Yes	Yes
NSB-20			Yes	Yes
NSB-23			Yes	Yes
NSB-26			Yes	Yes
NSB-30			Yes	Yes

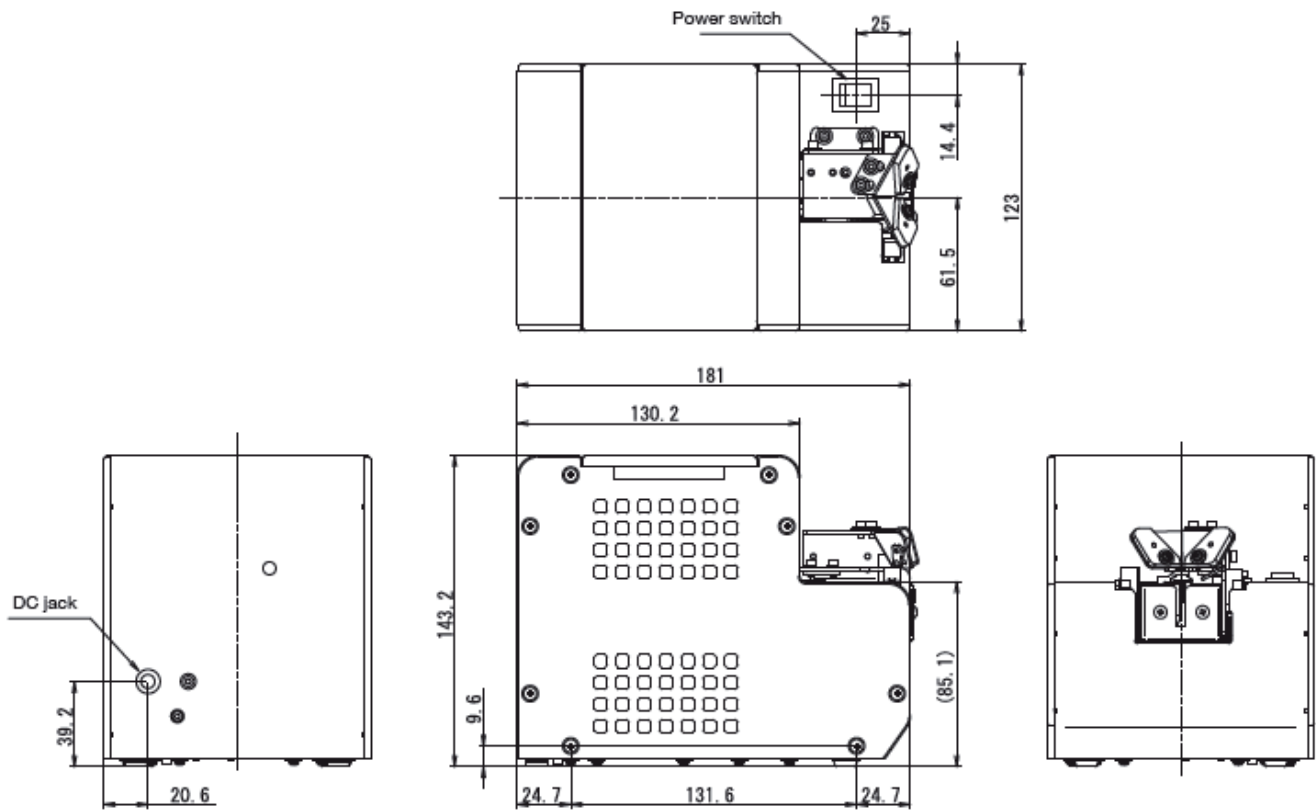

## NSBI serie

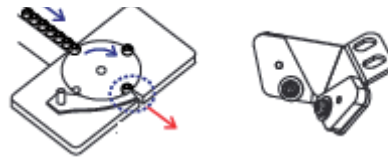

Take out type

- ▶ High Precision.
- ▶ Rotary separator allowing a high speed of distribution up to 1 screw every 0.9 sec.
- ▶ Increased durability thanks to a rotary separator.

### Suitable screws

Model	Suitable Ø screw body (mm)	Suitable Ø screw head (mm)	Suitable H screw (mm)	Screw shaft length (mm)
NSBI-10	1 (0,9 to 0,95)	1,2 to 4,5	0,35 to 1	1,6 to 10
NSBI-12	1,2 (1,1 to 1,15)	1,4 to 4,5	0,35 to 1	1,8 to 10
NSBI-14	1,4 (1,3 to 1,4)	1,7 to 4,5	0,35 to 1	2 to 10
NSBI-17	1,7 (1,6 to 1,7)	2 to 4,5	0,35 to 1	2,3 to 10
NSBI-20	2 (1,9 to 2,1)	2,4 to 6	0,35 to 4,5	2,6 to 20
NSBI-23	2,3 (2,2 to 2,4)	2,7 to 6	0,35 to 4,5	2,9 to 20
NSBI-26	2,6 (2,5 to 2,7)	3 to 6	0,35 to 4,5	3,2 to 20
NSBI-30	3 (2,9 to 3,2)	3,5 to 6	0,35 to 4,5	3,6 to 20

### Dispensers

Model	Code
Dispenser OHTAKE NSBI-10 screw 1.0 mm	<b>4-1510616</b>
Dispenser OHTAKE NSBI-12 screw 1.2 mm	<b>4-1510617</b>
Dispenser OHTAKE NSBI-14 screw 1.4 mm	<b>4-1510618</b>
Dispenser OHTAKE NSBI-17 screw 1.7 mm	<b>4-1510619</b>
Dispenser OHTAKE NSBI-20 screw 2.0 mm	<b>4-1510620</b>
Dispenser OHTAKE NSBI-23 screw 2.3 mm	<b>4-1510621</b>
Dispenser OHTAKE NSBI-26 screw 2.6 mm	<b>4-1510622</b>
Dispenser OHTAKE NSBI-30 screw 3.0 mm	<b>4-1510623</b>

### Additional rails

Model	Code
P/NSBI Rail BI10 for screw 1.0 mm	<b>4-1510624</b>
P/NSBI Rail BI12 for screw 1.2 mm	<b>4-1510625</b>
P/NSBI Rail BI14 for screw 1.4 mm	<b>4-1510626</b>
P/NSBI Rail BI17 for screw 1.7 mm	<b>4-1510627</b>
P/NSBI Rail BI20 for screw 2.0 mm	<b>4-1510628</b>
P/NSBI Rail BI23 for screw 2,3 mm	<b>4-1510629</b>
P/NSBI Rail BI26 for screw 2.6 mm	<b>4-1510630</b>
P/NSBI Rail BI30 for screw 3.0 mm	<b>4-1510631</b>

## Features

Model	External dimensions	Screw capacity	Overload protection/recovery circuit	External signal line
NSBI-10	123 x 181 x 145 (H)	ENV 80 CC	Yes	Yes
NSBI-12			Yes	Yes
NSBI-14			Yes	Yes
NSBI-17			Yes	Yes
NSBI-20			Yes	Yes
NSBI-23			Yes	Yes
NSBI-26			Yes	Yes
NSBI-30			Yes	Yes

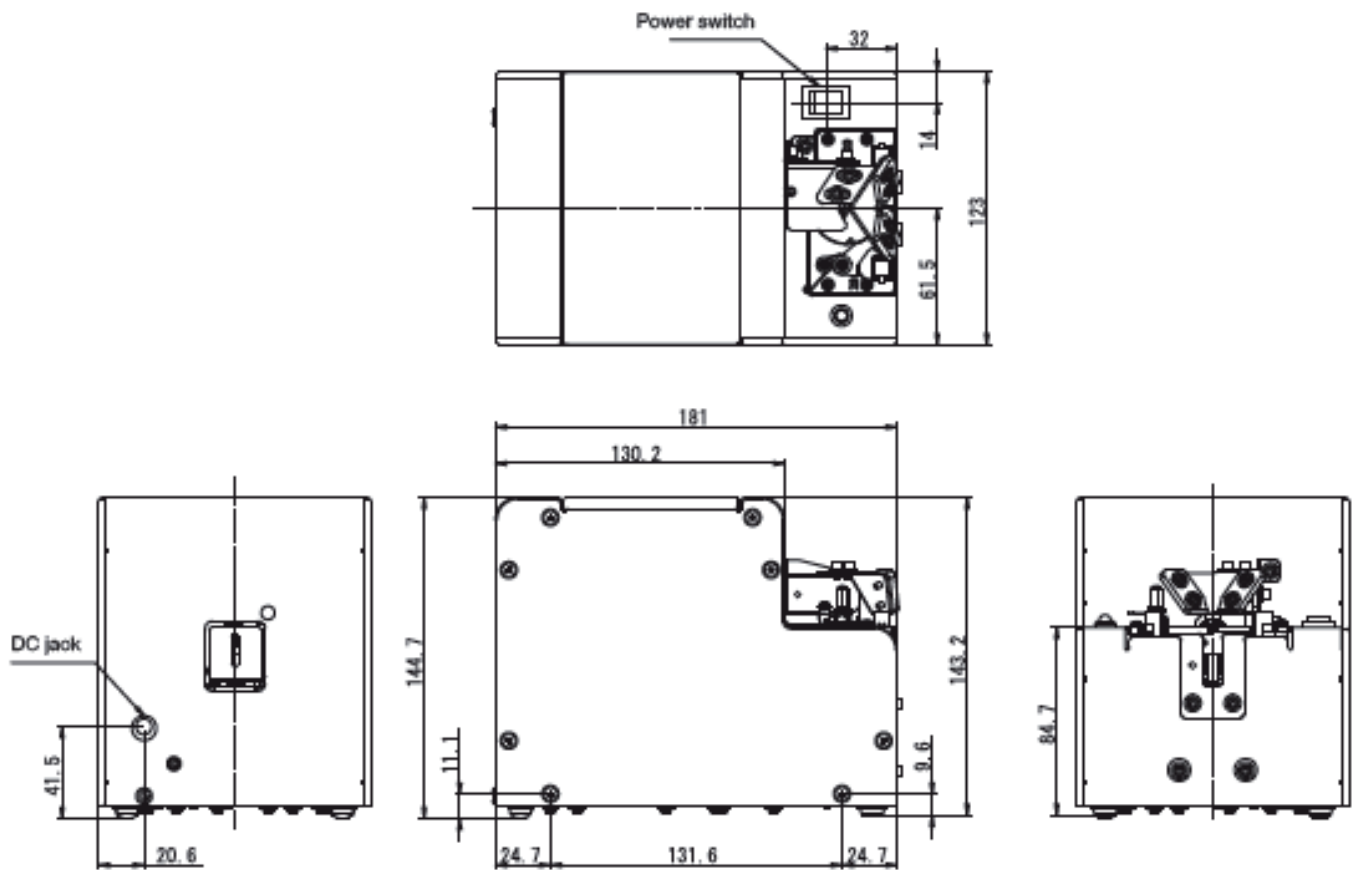



## NSBC serie

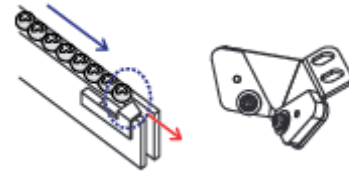

Take out type

- ▶ Display of the number of screws distributed (counter per increment).
- ▶ Display of the number of screws remaining to be dispensed (counter by decrementing from a configurable setpoint).

### Suitable screws

Model	Suitable Ø screw body (mm)	Suitable Ø screw head (mm)	Suitable H screw (mm)	Screw shaft length (mm)
NSBC-10	1 (0,9 à 0,95)	1,2 à 4,5	0,35 à 1	1,6 à 10
NSBC-12	1,2 (1,1 à 1,15)	1,4 à 4,5	0,35 à 1	1,8 à 10
NSBC-14	1,4 (1,3 à 1,4)	1,7 à 4,5	0,35 à 1	2 à 10
NSBC-17	1,7 (1,6 à 1,7)	2 à 4,5	0,35 à 1	2,3 à 10
NSBC-20	2 (1,9 à 2,1)	2,4 à 6	0,35 à 4,5	2,6 à 20
NSBC-23	2,3 (2,2 à 2,4)	2,7 à 6	0,35 à 4,5	2,9 à 20
NSBC-26	2,6 (2,5 à 2,7)	3 à 6	0,35 à 4,5	3,2 à 20
NSBC-30	3 (2,9 à 3,2)	3,5 à 6	0,35 à 4,5	3,6 à 20

### Dispensers

Model	Code
Dispenser OHTAKE NSBC-10 screw 1.0 mm	<b>4-1510648</b>
Dispenser OHTAKE NSBC-12 screw 1.2 mm	<b>4-1510649</b>
Dispenser OHTAKE NSBC-14 screw 1.4 mm	<b>4-1510650</b>
Dispenser OHTAKE NSBC-17 screw 1.7 mm	<b>4-1510651</b>
Dispenser OHTAKE NSBC-20 screw 2.0 mm	<b>4-1510652</b>
Dispenser OHTAKE NSBC-23 screw 2.3 mm	<b>4-1510653</b>
Dispenser OHTAKE NSBC-26 screw 2.6 mm	<b>4-1510654</b>
Dispenser OHTAKE NSBC-30 screw 3.0 mm	<b>4-1510655</b>

### Additional rails

Model	Code
P/NSB & NSBC Rail BI10 for screw 1.0 mm	<b>4-1510549</b>
P/NSB & NSBC Rail BI12 for screw 1.2 mm	<b>4-1510550</b>
P/NSB & NSBC Rail BI14 for screw 1.4 mm	<b>4-1510551</b>
P/NSB & NSBC Rail BI17 for screw 1.7 mm	<b>4-1510552</b>
P/NSB & NSBC Rail BI20 for screw 2.0 mm	<b>4-1510553</b>
P/NSB & NSBC Rail BI23 for screw 2,3 mm	<b>4-1510554</b>
P/NSB & NSBC Rail BI26 for screw 2.6 mm	<b>4-1510555</b>
P/NSB & NSBC Rail BI30 for screw 3.0 mm	<b>4-1510556</b>

## Features

Model	External dimensions	Screw capacity	Overload protection/recovery circuit	External signal line
NSBC-10	123 x 181 x 144 (H)	ENV 80 CC	Yes	Yes
NSBC-12			Yes	Yes
NSBC-14			Yes	Yes
NSBC-17			Yes	Yes
NSBC-20			Yes	Yes
NSBC-23			Yes	Yes
NSBC-26			Yes	Yes
NSBC-30			Yes	Yes

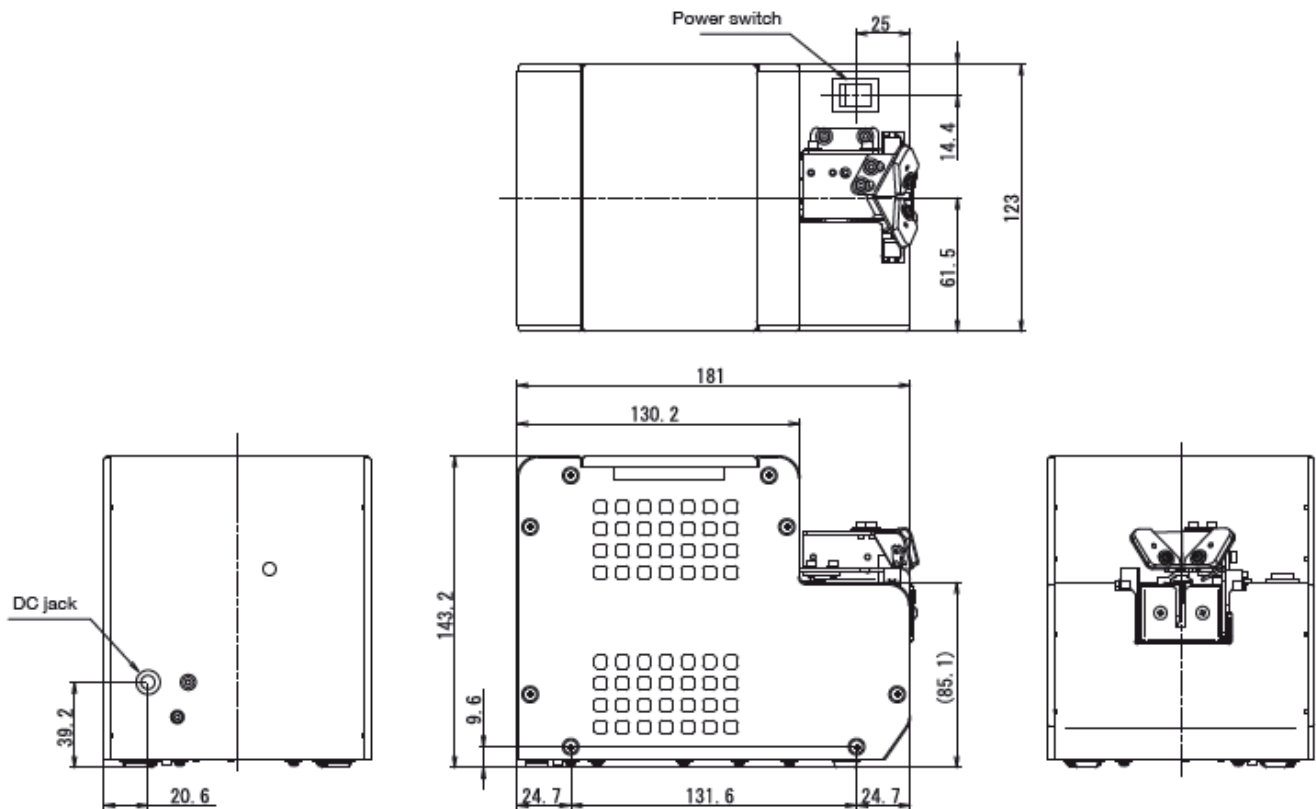

## SS serie

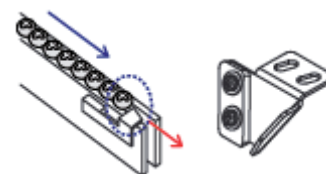

Take out type

- ▶ Small width for installation next to each other.
- ▶ Suitable for screws with a thin head.
- ▶ Adjustable conveying speed.

### Suitable screws

Model	Suitable $\varnothing$ screw body (mm)	Suitable $\varnothing$ screw head (mm)	Suitable H screw (mm)	Suitable washer $\varnothing$ (mm)	Screw shaft length (mm)
SS-1210	1 (0,9 to 0,95)	1,2 to 2	0,35 to 1	NA	1,6 to 10
SS-1212	1,2 (1,1 to 1,15)	1,4 to 2,3	0,35 to 1	NA	1,8 to 10
SS-1214	1,4 (1,3 to 1,4)	1,7 to 2,5	0,35 to 1	NA	2 to 10
SS-1217	1,7 (1,6 to 1,7)	2 to 3	0,35 to 1	NA	2,3 to 10
SS-1220	2 (1,9 to 2,1)	2,4 to 4	0,35 to 1,3	2,4 to 6	2,6 to 16
SS-2323	2,3 (2,2 to 2,4)	2,7 to 4	0,35 to 1,5	2,7 to 7	2,9 to 16
SS-2326	2,6 (2,5 to 2,7)	3 to 4,5	0,35 to 1,7	3 to 7,5	3,2 to 16
SS-2330	3 (2,9 to 3,2)	5 to 5,5	0,35 to 2	3,5 to 8	3,6 to 16

### Dispensers

Model	Code
Dispenser OHTAKE SS-1210 screw 1.0 mm	<b>4-1510170</b>
Dispenser OHTAKE SS-1212 screw 1.2 mm	<b>4-1510171</b>
Dispenser OHTAKE SS-1214 screw 1.4 mm	<b>4-1510172</b>
Dispenser OHTAKE SS-1217 screw 1.7 mm	<b>4-1510173</b>
Dispenser OHTAKE SS-1220 screw 2.0 mm	<b>4-1510174</b>
Dispenser OHTAKE SS-2323 screw 2.3 mm	<b>4-1510175</b>
Dispenser OHTAKE SS-2326 screw 2.6 mm	<b>4-1510176</b>
Dispenser OHTAKE SS-2330 screw 3.0 mm	<b>4-1510177</b>

### Additional rails

Model	Code
P/SS-12 Rail WR10 for screw 1.0 mm	<b>4-1510210</b>
P/SS-12 Rail WR12 for screw 1.2 mm	<b>4-1510211</b>
P/SS-12 Rail WR14 for screw 1.4 mm	<b>4-1510212</b>
P/SS-12 Rail WR17 for screw 1.7 mm	<b>4-1510213</b>
P/SS-12 Rail WR20 for screw 2.0 mm	<b>4-1510214</b>
P/SS-12 Rail WR23 for screw 2.3 mm	<b>4-1510215</b>
P/SS-12 Rail WR26 for screw 2.6 mm	<b>4-1510216</b>
P/SS-12 Rail WR30 for screw 3.0 mm	<b>4-1510217</b>

## Features

Model	External dimensions	Screw capacity	Overload protection/recovery circuit	External signal line
SS-1210	55 x 205 x 143 (H)	ENV 40 CC	Yes	Yes
SS-1212			Yes	Yes
SS-1214			Yes	Yes
SS-1217			Yes	Yes
SS-1220			Yes	Yes
SS-2323			Yes	Yes
SS-2326			Yes	Yes
SS-2330			Yes	Yes

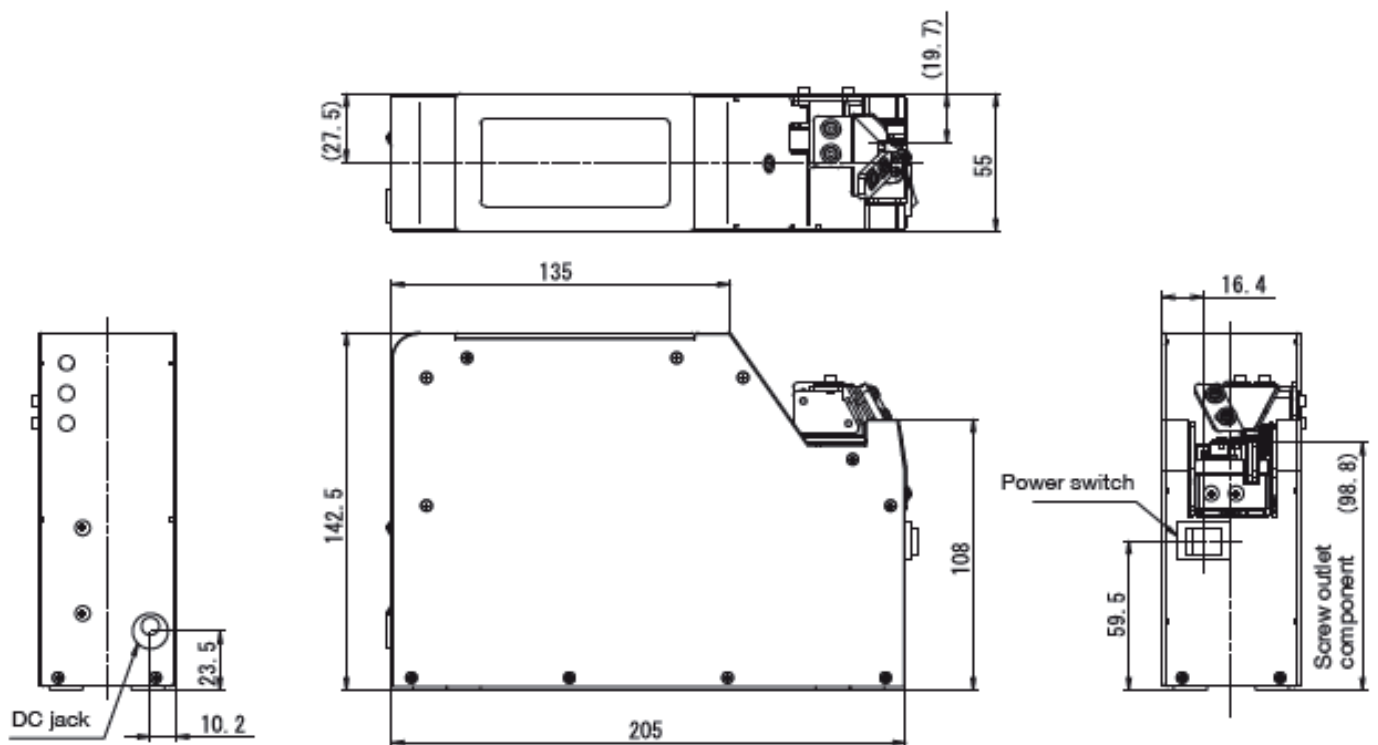

## OM-26M serie

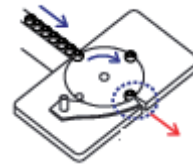
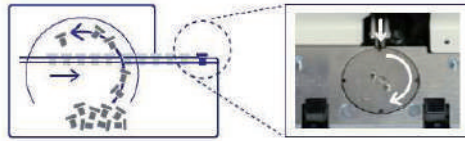

Take out type

- ▶ Rotative separator allowing a high speed of distribution up to 1 screw every 0.9 sec.
- ▶ High capacity up to 300 CC (about 780 M3 x 12 screws).
- ▶ Brushless motor for long life.

### Suitable screws

Model	Suitable Ø screw body (mm)	Suitable Ø screw head (mm)	Suitable H screw (mm)	Suitable washer Ø (mm)	Screw shaft length (mm)
OM-26M20	2 (1,9 to 2,1)	2,4 to 6	0,35 to 6	2,4 to 10	2,6 to 25
OM-26M23	2,3 (2,2 to 2,4)	2,7 to 6	0,35 to 6	2,7 to 10	2,9 to 25
OM-26M26	2,6 (2,5 to 2,7)	3 to 6	0,35 to 6	3 to 10	3,2 to 25
OM-26M30	3 (2,9 to 3,2)	3,5 to 6	0,35 to 6	3,5 to 11	3,6 to 25
OM-26M35	3,5 (3,4 to 3,7)	4 to 8	0,35 to 6,5	4 to 11	4,1 to 25
OM-26M40	4 (3,8 to 4,2)	4,5 to 8	0,35 to 6,5	4,5 to 12	4,6 to 25
OM-26M50	5 (4,8 to 5,2)	5,5 to 10	0,35 to 7	5,5 to 12	5,6 to 25
OM-26M60	6 (5,8 to 6,2)	6,5 to 11	0,35 to 7,5	6,5 to 12	6,6 to 25

### Dispensers

Model	Code
Dispenser OHTAKE OM-26M20 screw 2.0 mm	<b>4-1510600</b>
Dispenser OHTAKE OM-26M23 screw 2.3 mm	<b>4-1510601</b>
Dispenser OHTAKE OM-26M26 screw 2.6 mm	<b>4-1510602</b>
Dispenser OHTAKE OM-26M30 screw 3.0 mm	<b>4-1510603</b>
Dispenser OHTAKE OM-26M35 screw 3.5 mm	<b>4-1510604</b>
Dispenser OHTAKE OM-26M40 screw 4.0 mm	<b>4-1510605</b>
Dispenser OHTAKE OM-26M50 screw 5.0 mm	<b>4-1510606</b>
Dispenser OHTAKE OM-26M60 screw 6.0 mm	<b>4-1510607</b>

### Additional rails

Model	Code
P/OM-26M Rail OMM20 for screw 2.0 mm	<b>4-1510608</b>
P/OM-26M Rail OMM23 for screw 2.3 mm	<b>4-1510609</b>
P/OM-26M Rail OMM26 for screw 2.6 mm	<b>4-1510610</b>
P/OM-26M Rail OMM30 for screw 3.0 mm	<b>4-1510611</b>
P/OM-26M Rail OMM35 for screw 3.5 mm	<b>4-1510612</b>
P/OM-26M Rail OMM40 for screw 4.0 mm	<b>4-1510613</b>
P/OM-26M Rail OMM50 for screw 5.0 mm	<b>4-1510614</b>
P/OM-26M Rail OMM60 for screw 6.0 mm	<b>4-1510615</b>

## Features

Model	External dimensions	Screw capacity	Overload protection/recovery circuit	External signal line
OM-26M20	119 x 226 x 152 (H)	ENV 300 CC	Yes	Yes
OM-26M23			Yes	Yes
OM-26M26			Yes	Yes
OM-26M30			Yes	Yes
OM-26M35			Yes	Yes
OM-26M40			Yes	Yes
OM-26M50			Yes	Yes
OM-26M60			Yes	Yes

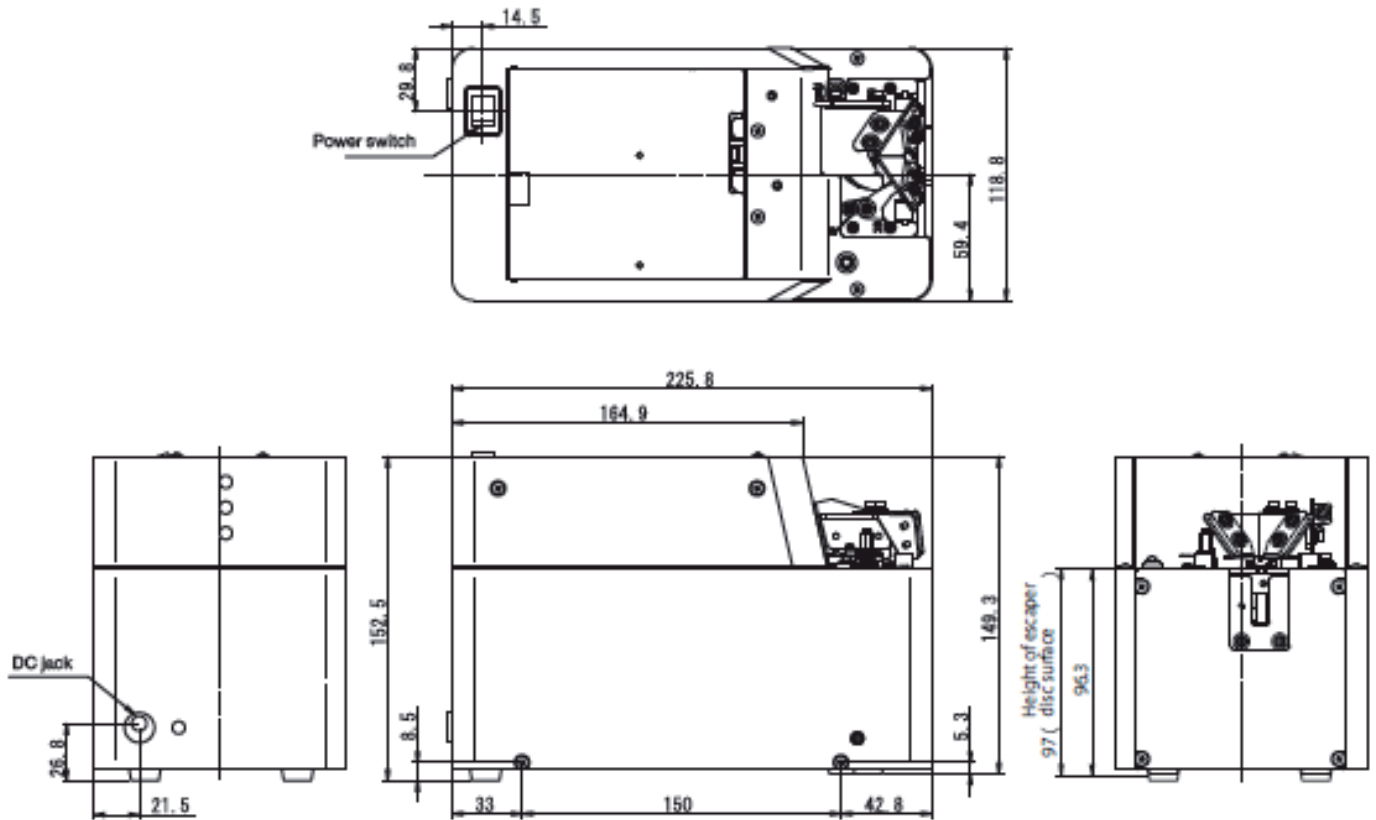

# AUTOMATIC SCREW PRESENTERS FOR SCREW PICKING UP BY VACUUM OR FOR USE IN AUTOMATIC STATIONS

## NJR serie

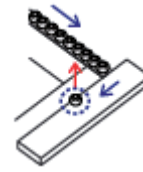

- ▶ Suitable for robotic applications.
- ▶ Side separation of the screw.
- ▶ Allows stable presentation of SW screws or screws with washers.

## Suitable screws

Model	Suitable $\varnothing$ screw body (mm)	Suitable $\varnothing$ screw head (mm)	Suitable H screw (mm)	Suitable washer $\varnothing$ (mm)	Screw shaft length (mm)
NJR 20	2 (1,8 to 2,1)	3 to 3,5	0,5 to 5,5	3 to 9,8	2,6 to 18
NJR 23	2,3 (2,1 to 2,4)	3 to 4	0,5 to 5,5	3 to 9,8	2,9 to 18
NJR 26	2,6 (2,4 to 2,7)	3,6 to 4,5	0,5 to 5,5	3,6 to 9,8	3,2 to 18
NJR 30	3 (2,8 to 3,2)	4 to 5,5	0,5 to 5,5	4 to 9,8	3,6 to 18
NJR 35	3,5 (3,3 to 3,7)	4,8 to 8	0,5 to 8	4,8 to 11,5	4,1 to 18
NJR 40	4 (3,8 to 4,3)	5,4 to 8	0,5 to 8	5,4 to 11,5	4,6 to 18
NJR 45	5 (4,8 to 5,1)	6,2 to 10	0,5 to 8	6,2 to 11,5	5,6 to 18

## Dispensers

Model	Code
Dispenser OHTAKE NJR23 screw 2.0 mm	<b>4-1510230</b>
Dispenser OHTAKE NJR23 screw 2.3 mm	<b>4-1510231</b>
Dispenser OHTAKE NJR23 screw 2.6 mm	<b>4-1510232</b>
Dispenser OHTAKE NJR23 screw 3.0 mm	<b>4-1510233</b>
Dispenser OHTAKE NJR45 screw 3.5 mm	<b>4-1510234</b>
Dispenser OHTAKE NJR45 screw 4.0 mm	<b>4-1510235</b>
Dispenser OHTAKE NJR45 screw 5.0 mm	<b>4-1510236</b>

## Additional rails

Model	Code
P/NJR-23 Rail RR20 for screw 2.0 mm	<b>4-1510567</b>
P/NJR-23 Rail RR23 for screw 2.3 mm	<b>4-1510568</b>
P/NJR-23 Rail RR26 for screw 2.6 mm	<b>4-1510569</b>
P/NJR-23 Rail RR30 for screw 3.0 mm	<b>4-1510570</b>
P/NJR-45 Rail RR35 for screw 3.5 mm	<b>4-1510571</b>
P/NJR-45 Rail RR40 for screw 4.0 mm	<b>4-1510572</b>
P/NJR-45 Rail RR50 for screw 5.0 mm	<b>4-1510573</b>

## Features

Model	External dimensions	Screw capacity	Overload protection/recovery circuit	External signal line
NJR-20	134 x 274 x 139 (H)	ENV 150 CC	Yes	Yes
NJR-23			Yes	Yes
NJR-26			Yes	Yes
NJR-30			Yes	Yes
NJR-35			Yes	Yes
NJR-40			Yes	Yes
NJR-45			Yes	Yes

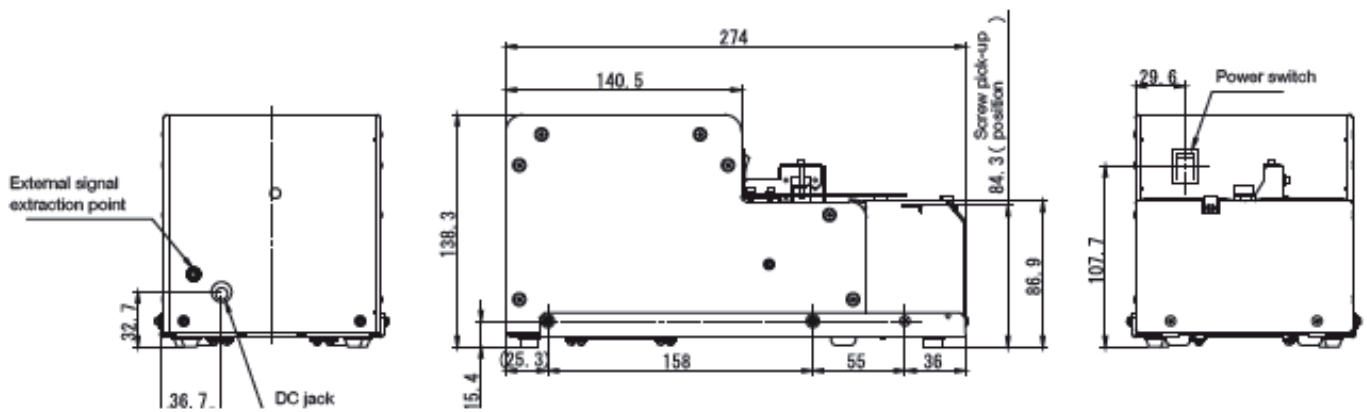
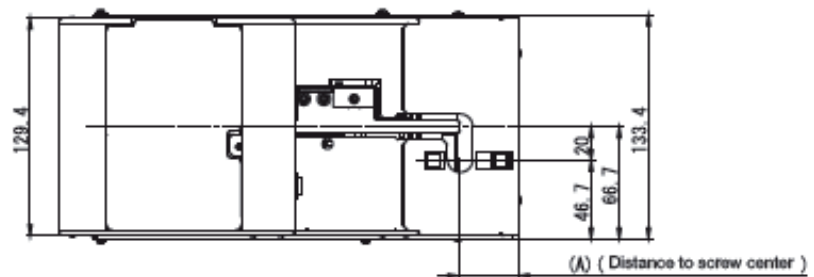



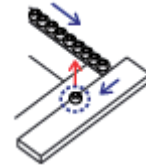

- ▶ Suitable for robotic applications.
- ▶ Side separation of the screw.
- ▶ Allows stable presentation of SW screws or screws with washers.
- ▶ Screw length up to 25 mm.

## Suitable screws

Model	Suitable Ø screw body (mm)	Suitable Ø screw head (mm)	Suitable H screw (mm)	Suitable washer Ø (mm)	Screw shaft length (mm)
NJRL 20	2 (1,8 to 2,1)	3 to 3,5	0,5 to 5,5	3 to 9,8	2,6 to 25
NJRL 23	2,3 (2,1 to 2,4)	3 to 4	0,5 to 5,5	3 to 9,8	2,9 to 25
NJRL 26	2,6 (2,4 to 2,7)	3,6 to 4,5	0,5 to 5,5	3,6 to 9,8	3,2 to 25
NJRL 30	3 (2,8 to 3,2)	4 to 5,5	0,5 to 5,5	4 to 9,8	3,6 to 25
NJRL 35	3,5 (3,3 to 3,7)	4,8 to 8	0,5 to 8	4,8 to 11,5	4,1 to 25
NJRL 40	4 (3,8 to 4,3)	5,4 to 8	0,5 to 8	5,4 to 11,5	4,6 to 25
NJRL 45	5 (4,8 to 5,1)	6,2 to 10	0,5 to 8	6,2 to 11,5	5,6 to 25

## Dispensers

Model	Code
Dispenser OHTAKE NJRL-2320 screw 2.0 mm	<b>4-1510507</b>
Dispenser OHTAKE NJRL-2323 screw 2.3 mm	<b>4-1510508</b>
Dispenser OHTAKE NJRL-2326 screw 2.6 mm	<b>4-1510509</b>
Dispenser OHTAKE NJRL-2330 screw 3.0 mm	<b>4-1510510</b>
Dispenser OHTAKE NJRL-4535 screw 3.5 mm	<b>4-1510511</b>
Dispenser OHTAKE NJRL-4540 screw 4.0 mm	<b>4-1510513</b>
Dispenser OHTAKE NJRL-4550 screw 5.0 mm	<b>4-1510514</b>

## Additional rails

Model	Code
P/NJRL-23 Rail RRL20 for screw 2.0 mm	<b>4-1500034</b>
P/NJRL-23 Rail RRL23 for screw 2.3 mm	<b>4-1500037</b>
P/NJRL-23 Rail RRL26 for screw 2.6 mm	<b>4-1500038</b>
P/NJRL-23 Rail RRL30 for screw 3.0 mm	<b>4-1500039</b>
P/NJRL-45 Rail RRL35 for screw 3.5 mm	<b>4-1500040</b>
P/NJRL-45 Rail RRL40 for screw 4.0 mm	<b>4-1500041</b>
P/NJRL-45 Rail RRL50 for screw 5.0 mm	<b>4-1500043</b>

## Features

Model	External dimensions	Screw capacity	Overload protection/recovery circuit	External signal line
NJRL-20	134 x 274 x 139 (H)	ENV 150 CC	Yes	Yes
NJRL-23			Yes	Yes
NJRL-26			Yes	Yes
NJRL-30			Yes	Yes
NJRL-35			Yes	Yes
NJRL-40			Yes	Yes
NJRL-45			Yes	Yes

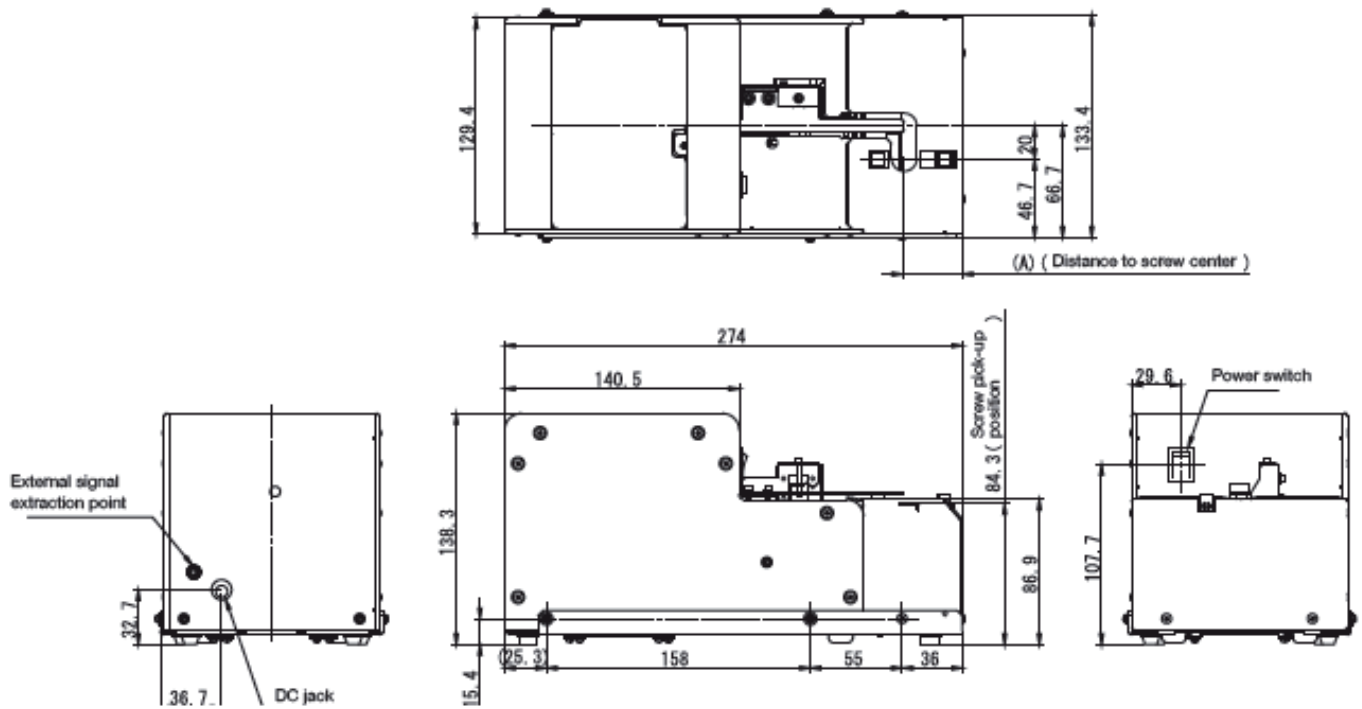

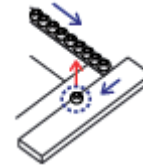

- ▶ Suitable for robotic applications.
- ▶ Side separation of the screw.

## Suitable screws

Model	Suitable Ø screw body (mm)	Suitable Ø screw head (mm)	Suitable H screw (mm)	Screw shaft length (mm)
NSR 10	1 (0,9 to 0,95)	1,2 to 4,5	0,35 to 1	1,6 to 10
NSR 12	1,2 (1,1 to 1,15)	1,4 to 4,5	0,35 to 1	1,8 to 10
NSR 14	1,4 (1,3 to 1,4)	1,7 to 4,5	0,35 to 1	2 to 10
NSR 17	1,7 (1,6 to 1,7)	2 to 4,5	0,35 to 1	2,3 to 10
NSR 20	2 (1,9 to 2,1)	2,4 to 6	0,35 to 4,5	2,6 to 20
NSR 23	2,3 (2,2 to 2,4)	2,7 to 6	0,35 to 4,5	2,9 to 20
NSR 26	2,6 (2,5 to 2,7)	3 to 6	0,35 to 4,5	3,2 to 20
NSR 30	3 (2,9 to 3,2)	3,5 to 6	0,35 to 4,5	3,6 to 20

## Dispensers

Model	Code
Dispenser OHTAKE NSR-10 screw 1.0 mm	<b>4-1510582</b>
Dispenser OHTAKE NSR-12 screw 1.2 mm	<b>4-1510583</b>
Dispenser OHTAKE NSR-14 screw 1.4 mm	<b>4-1510584</b>
Dispenser OHTAKE NSR-17 screw 1.7 mm	<b>4-1510585</b>
Dispenser OHTAKE NSR-20 screw 2.0 mm	<b>4-1510586</b>
Dispenser OHTAKE NSR-23 screw 2.3 mm	<b>4-1510587</b>
Dispenser OHTAKE NSR-26 screw 2.6 mm	<b>4-1510588</b>
Dispenser OHTAKE NSR-30 screw 3.0 mm	<b>4-1510589</b>

## Additional rails

Model	Code
P/NSR Rail SRR10 for screw 1.0 mm	<b>4-1510557</b>
P/NSR Rail SRR12 for screw 1.2 mm	<b>4-1510558</b>
P/NSR Rail SRR14 for screw 1.4 mm	<b>4-1510559</b>
P/NSR Rail SRR17 for screw 1.7 mm	<b>4-1510560</b>
P/NSR Rail SRR20 for screw 2.0 mm	<b>4-1510561</b>
P/NSR Rail SRR23 for screw 2.3 mm	<b>4-1510562</b>
P/NSR Rail SRR26 for screw 2.6 mm	<b>4-1510563</b>
P/NSR Rail SRR30 for screw 3.0 mm	<b>4-1510564</b>

## Features

Model	External dimensions	Screw capacity	Overload protection/recovery circuit	External signal line
NSR-10	123 x 181 x 145 (H)	ENV 80 CC	Yes	Yes
NSR-12			Yes	Yes
NSR-14			Yes	Yes
NSR-17			Yes	Yes
NSR-20			Yes	Yes
NSR-23			Yes	Yes
NSR-26			Yes	Yes
NSR-30			Yes	Yes

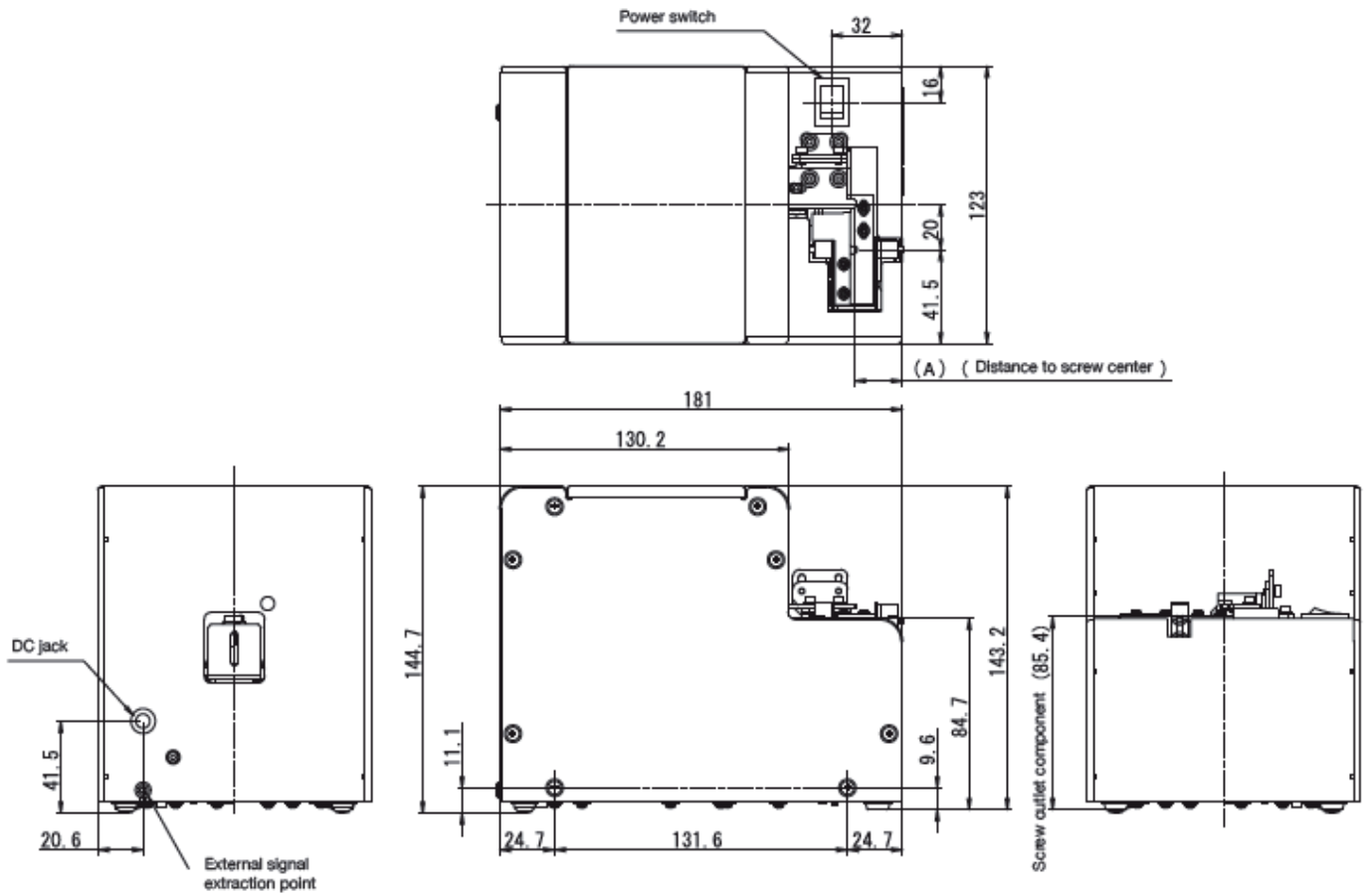

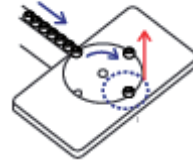

- ▶ Suitable for robotic applications.
- ▶ Rotative separator for an optimized cycle time (approx. 0.9 sec).

## Suitable screws

Model	Suitable Ø screw body (mm)	Suitable Ø screw head (mm)	Suitable H screw (mm)	Screw shaft length (mm)
NSRI 10	0,9 to 0,95	1,2 to 4,5	0,35 to 1	1,6 to 10
NSRI 12	1,1 to 1,15	1,4 to 4,5	0,35 to 1	1,8 to 10
NSRI 14	1,4 (1,3 to 1,4)	1,7 to 4,5	0,35 to 1	2 to 10
NSRI 17	1,7 (1,6 to 1,7)	2 to 4,5	0,35 to 1	2,3 to 10
NSRI 20	2 (1,9 to 2,1)	2,4 to 6	0,35 to 4,5	2,6 to 20
NSRI 23	2,3 (2,2 to 2,4)	2,7 to 6	0,35 to 4,5	2,9 to 20
NSRI 26	2,6 (2,5 to 2,7)	3 to 6	0,35 to 4,5	3,2 to 20
NSRI 30	3 (2,9 to 3,2)	3,5 to 6	0,35 to 4,5	3,6 to 20

## Dispensers

Model	Code
Dispenser OHTAKE NSRI-10 screw 1.0 mm	<b>4-1510632</b>
Dispenser OHTAKE NSRI-12 screw 1.2 mm	<b>4-1510633</b>
Dispenser OHTAKE NSRI-14 screw 1.4 mm	<b>4-1510634</b>
Dispenser OHTAKE NSRI-17 screw 1.7 mm	<b>4-1510635</b>
Dispenser OHTAKE NSRI-20 screw 2.0 mm	<b>4-1510636</b>
Dispenser OHTAKE NSRI-23 screw 2.3 mm	<b>4-1510637</b>
Dispenser OHTAKE NSRI-26 screw 2.6 mm	<b>4-1510638</b>
Dispenser OHTAKE NSRI-30 screw 3.0 mm	<b>4-1510639</b>

## Additional rails

Model	Code
P/NSRI Rail RI10 for screw 1.0 mm	<b>4-1510640</b>
P/NSRI Rail RI12 for screw 1.2 mm	<b>4-1510641</b>
P/NSRI Rail RI14 for screw 1.4 mm	<b>4-1510642</b>
P/NSRI Rail RI17 for screw 1.7 mm	<b>4-1510643</b>
P/NSRI Rail RI20 for screw 2.0 mm	<b>4-1510644</b>
P/NSRI Rail RI23 for screw 2.3 mm	<b>4-1510645</b>
P/NSRI Rail RI26 for screw 2.6 mm	<b>4-1510646</b>
P/NSRI Rail RI30 for screw 3.0 mm	<b>4-1510647</b>

## Features

Model	External dimensions	Screw capacity	Overload protection/recovery circuit	External signal line
NSRI-10	123 x 181 x 145 (H)	ENV 80 CC	Yes	Yes
NSRI-12			Yes	Yes
NSRI-14			Yes	Yes
NSRI-17			Yes	Yes
NSRI-20			Yes	Yes
NSRI-23			Yes	Yes
NSRI-26			Yes	Yes
NSRI-30			Yes	Yes

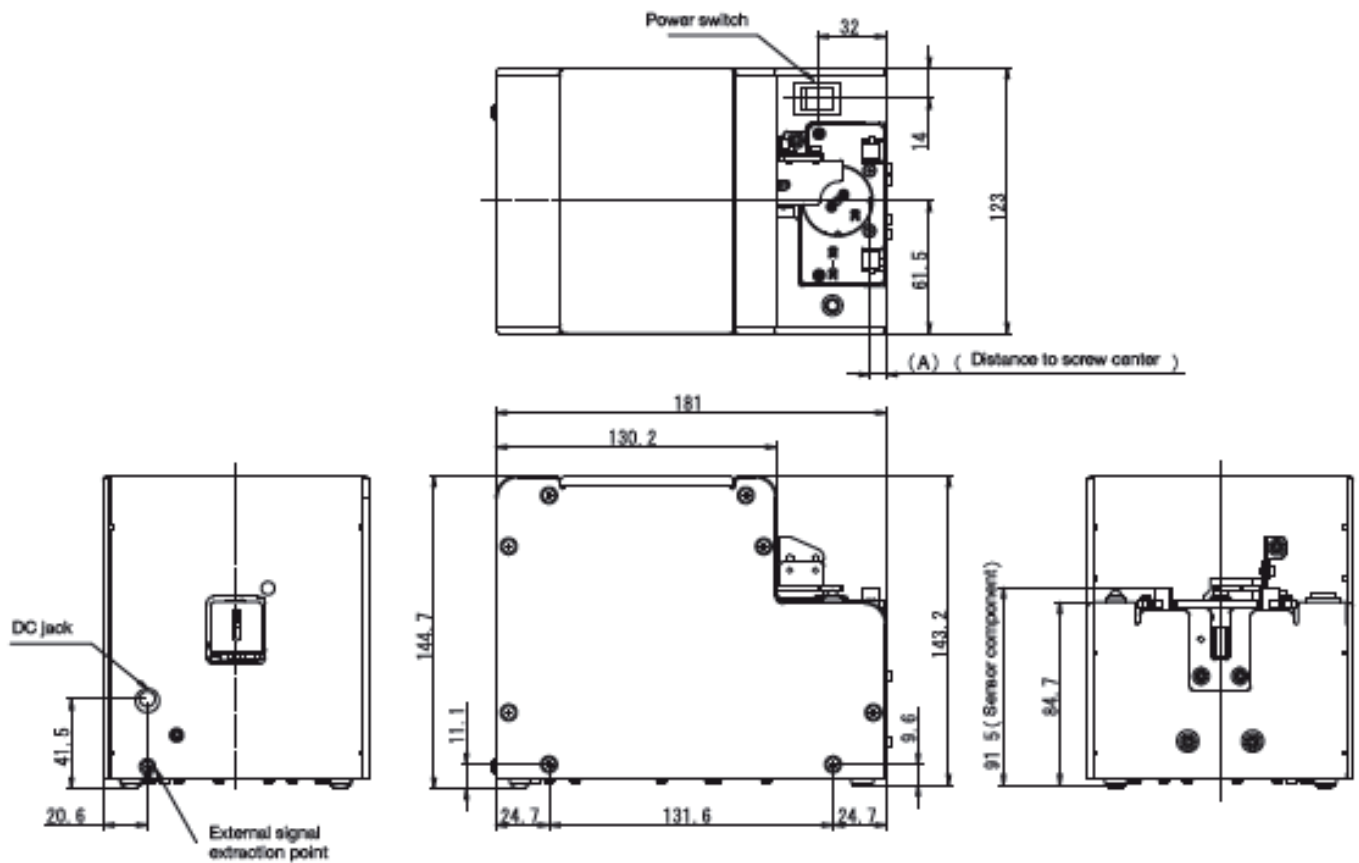

## OM-26R serie

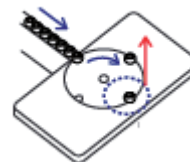

- ▶ Suitable for robotic applications.
- ▶ Rotative separator for an optimized cycle time (approx. 0.9 sec).
- ▶ Screw length up to 25 mm.

### Suitable screws

Model	Suitable Ø screw body (mm)	Suitable Ø screw head (mm)	Suitable H screw (mm)	Suitable washer Ø (mm)	Screw shaft length (mm)
OM-26R20	2 (1,9 to 2,1)	2,4 to 6	0,35 to 6	2,4 to 10	2,6 to 25
OM-26R23	2,3 (2,2 to 2,4)	2,7 to 6	0,35 to 6	2,7 to 10	2,9 to 25
OM-26R26	2,6 (2,5 to 2,7)	3 to 6	0,35 to 6	3 to 10	3,2 to 25
OM-26R30	3 (2,9 to 3,2)	3,5 to 6	0,35 to 6	3,5 to 11	3,6 to 25
OM-26R35	3,5 (3,4 to 3,7)	4 to 8	0,35 to 6,5	4 to 11	4,1 to 25
OM-26R40	4 (3,8 to 4,2)	4,5 to 8	0,35 to 6,5	4,5 to 12	4,6 to 25
OM-26R50	5 (4,8 to 5,2)	5,5 to 10	0,35 to 7	5,5 to 12	5,6 to 25
OM-26R60	6 ( 5,8 to 6,2)	6,5 to 11	0,35 to 7,5	6,5 to 12	6,6 to 25

### Dispensers

Model	Code
Dispenser OHTAKE OM-26R20 screw 2.0 mm	<b>4-1500076</b>
Dispenser OHTAKE OM-26R23 screw 2.3 mm	<b>4-1500078</b>
Dispenser OHTAKE OM-26R26 screw 2.6 mm	<b>4-1500080</b>
Dispenser OHTAKE OM-26R30 screw 3.0 mm	<b>4-1500082</b>
Dispenser OHTAKE OM-26R35 screw 3.5 mm	<b>4-1500084</b>
Dispenser OHTAKE OM-26R40 screw 4.0 mm	<b>4-1500086</b>
Dispenser OHTAKE OM-26R50 screw 5.0 mm	<b>4-1500088</b>
Dispenser OHTAKE OM-26R60 screw 6.0 mm	<b>4-1500051</b>

### Additional rails

Model	Code
P/OM - 26R Rail OMR20 for screw 2.0 mm	<b>4-1500077</b>
P/OM - 26R Rail OMR23 for screw 2.3 mm	<b>4-1500079</b>
P/OM - 26R Rail OMR26 for screw 2.6 mm	<b>4-1500081</b>
P/OM - 26R Rail OMR30 for screw 3.0 mm	<b>4-1500083</b>
P/OM - 26R Rail OMR35 for screw 3.5 mm	<b>4-1500085</b>
P/OM - 26R Rail OMR40 for screw 4.0 mm	<b>4-1500087</b>
P/OM - 26R Rail OMR50 for screw 5.0 mm	<b>4-1500089</b>
P/OM - 26R Rail OMR60 for screw 6.0 mm	<b>4-1500052</b>

## Features

Model	External dimensions	Screw capacity	Overload protection/recovery circuit	External signal line
OM-26R20	119 x 226 x 152 (H)	ENV 300 CC	Yes	Yes
OM-26R23			Yes	Yes
OM-26R26			Yes	Yes
OM-26R30			Yes	Yes
OM-26R35			Yes	Yes
OM-26R40			Yes	Yes
OM-26R50			Yes	Yes
OM-26R60			Yes	Yes

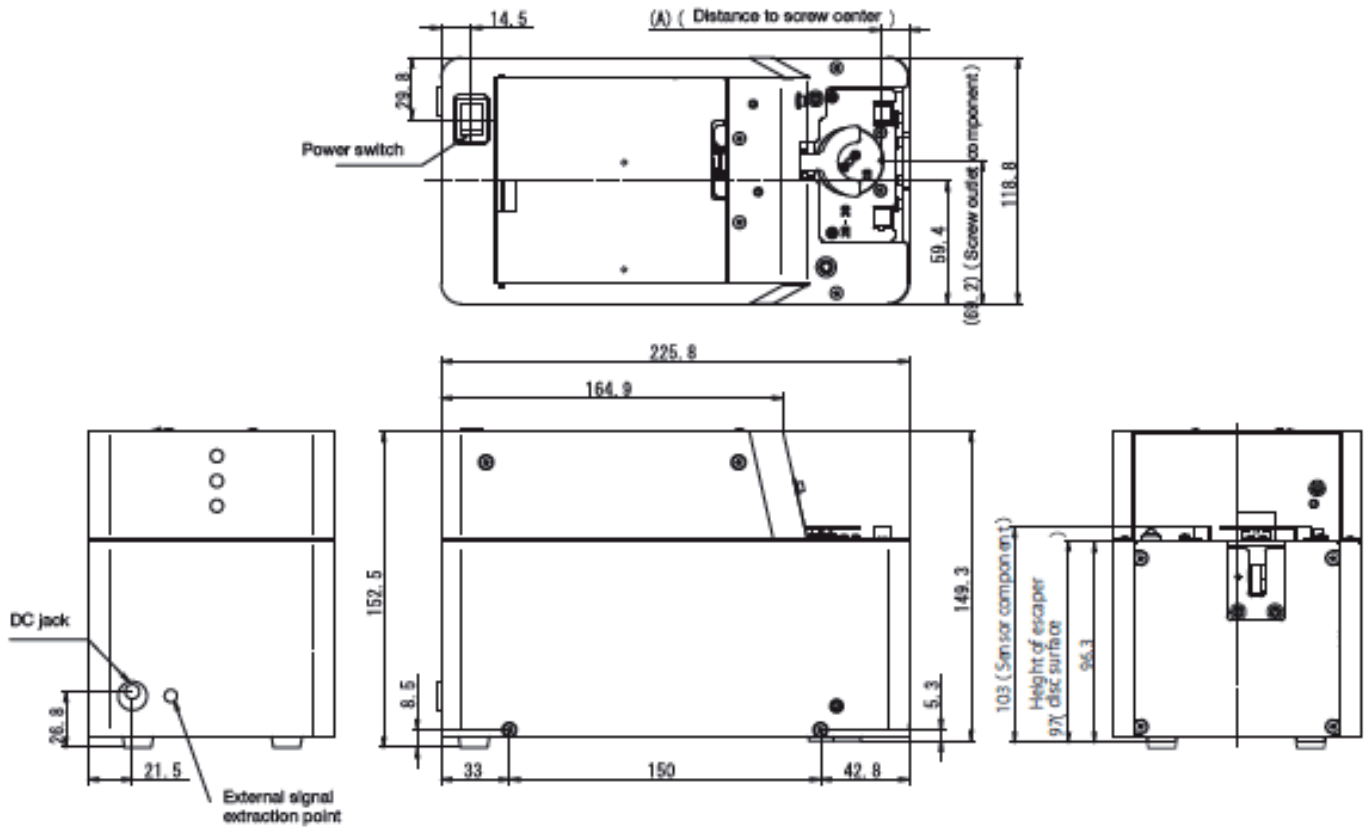



# AUTOMATIC SCREW PRESENTERS FOR PICKING BY QUANTITY

## FM-36 serie



- ▶ Counting of fixed quantities Between 1 and 99 screws.
- ▶ The horizontal rail system ensures a stable distribution without overlapping and obstruction.
- ▶ Accepts screws of different diameters thanks to a quick change of the rail.

### Suitable screws

Model	Suitable Ø screw body (mm)	Suitable Ø screw head (mm)	Suitable H screw (mm)	Suitable washer Ø (mm)	Screw shaft length (mm)
FM-3630	3 (2,8 to 3,1)	4 to 5,5	1 to 5,5	4 to 12	3,6 to 25
FM-3635	3,5 (3,3 to 3,7)	4,8 to 8	1 to 8	4,8 to 12	4,1 to 25
FM-3640	4 (3,8 to 4,1)	5,4 to 8	1 to 8	5,4 to 12	4,6 to 25
FM-3650	5 (4,8 to 5,1)	6,2 to 10	1 to 8	6,2 to 12	5,6 to 25
FM-3660	6 (5,8 to 6,2)	7,2 to 12	1 to 8	7,2 to 12	5,6 to 25

### Dispensers

Model	Code
Dispenser OHTAKE FM36 screw 3.0 mm	<b>4-1510590</b>
Dispenser OHTAKE FM36 screw 3.5 mm	<b>4-1510591</b>
Dispenser OHTAKE FM36 screw 4.0 mm	<b>4-1510592</b>
Dispenser OHTAKE FM36 screw 5.0 mm	<b>4-1510593</b>
Dispenser OHTAKE FM36 screw 6.0 mm	<b>4-1510594</b>

### Additional rails

Model	Code
P/FM-36 Rail FR30 for screw 3.0 mm	<b>4-1510595</b>
P/FM-36 Rail FR35 for screw 3.5 mm	<b>4-1510596</b>
P/FM-36 Rail FR40 for screw 4.0 mm	<b>4-1510597</b>
P/FM-36 Rail FR50 for screw 5.0 mm	<b>4-1510598</b>
P/FM-36 Rail FR60 for screw 6.0 mm	<b>4-1510599</b>

## Features

Model	External dimensions	Screw capacity	Overload protection/recovery circuit	External signal line
FM-3630	130 x 254 x 201 (H)	ENV 150 CC	Yes	Yes
FM-3635			Yes	Yes
FM-3640			Yes	Yes
FM-3650			Yes	Yes
FM-3660			Yes	Yes

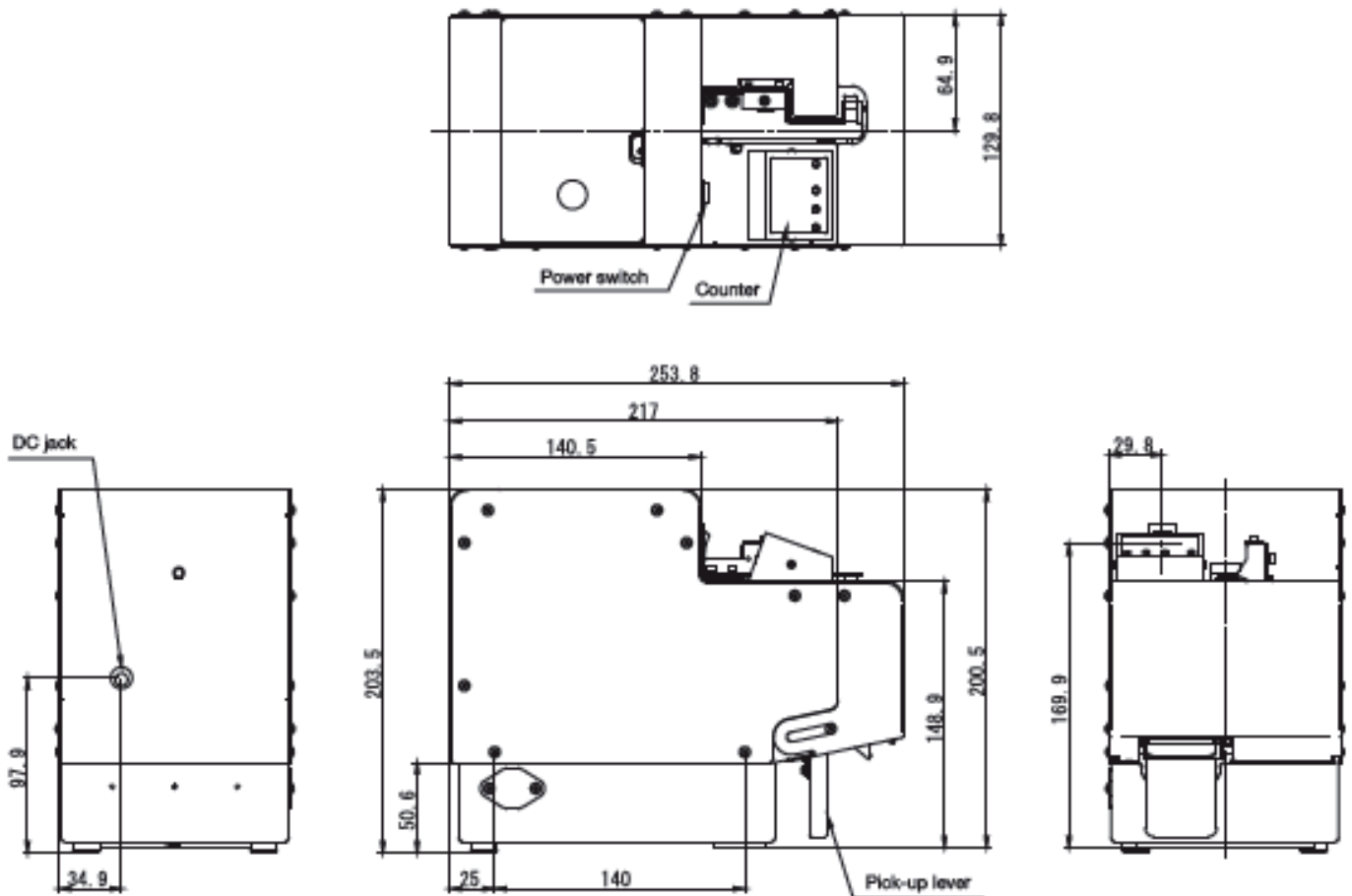

# ACCESSORIES AND SERVICES

## Additional vertical hoppers

- ▶ Easy installation: just line it up on top of the dispenser.
- ▶ Does not take up floor space.
- ▶ Increases distributor autonomy.
- ▶ Timer dispensing adjustment.



( T-510 + NSR )

### Compatibility

Model	Suitable dispensers
T-510S	NSB / NSR / NSBI / NSRI / NSRI-B
T-510J	NJ / NJR
T-510F	FM-36 / FME-36

### References

Hoppers	
Model	Code
Vertical hopper T-510S P/NSB NSR NSBI NSRI	<b>4-1510301</b>
Vertical hopper T-510J P/NJ NJR	<b>4-1510303</b>
Vertical hopper T-510F P/FM-36	<b>4-1510304</b>

### Features

Model	External dimensions	Screw capacity	Suitable $\varnothing$ screw body (mm)	External signal line (remaining quantity sensor)
T-510S	130 x 171 x 245 (H)	ENV 400 CC and 800 CC with optional extension	M1 to M6	Yes
T-510J				Yes
T-510F				Yes

**T-510S**

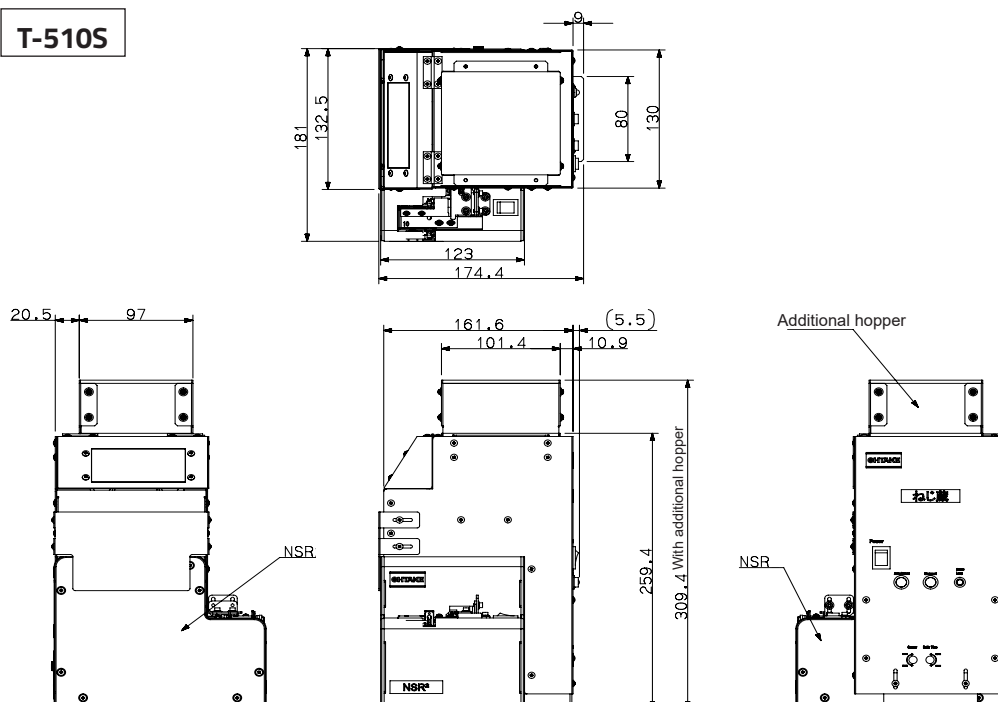

T-510J

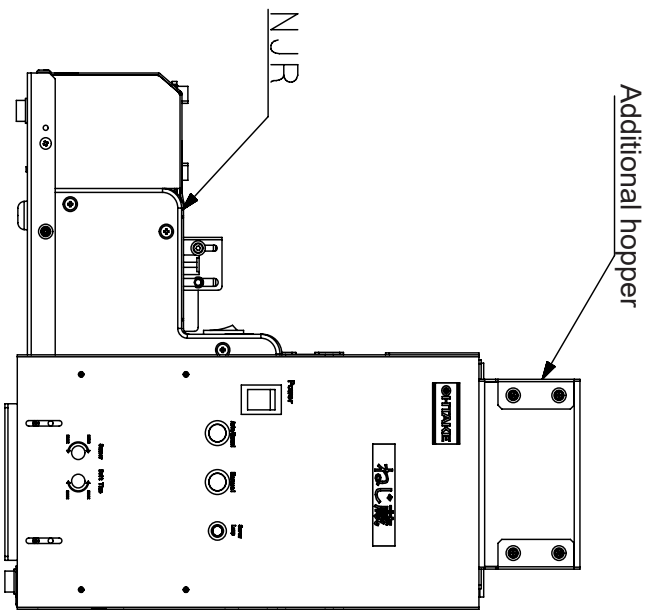
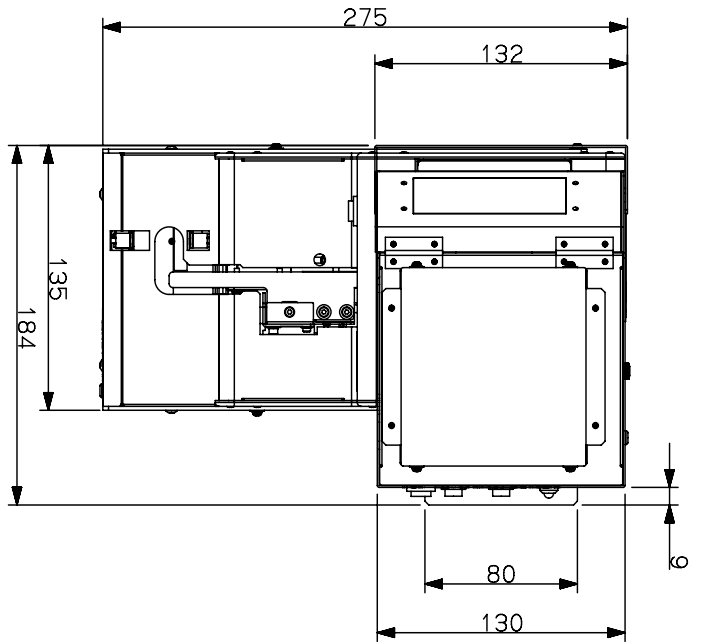
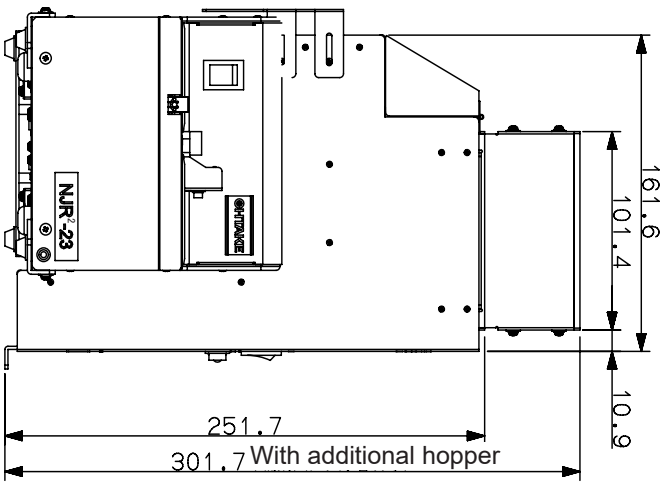
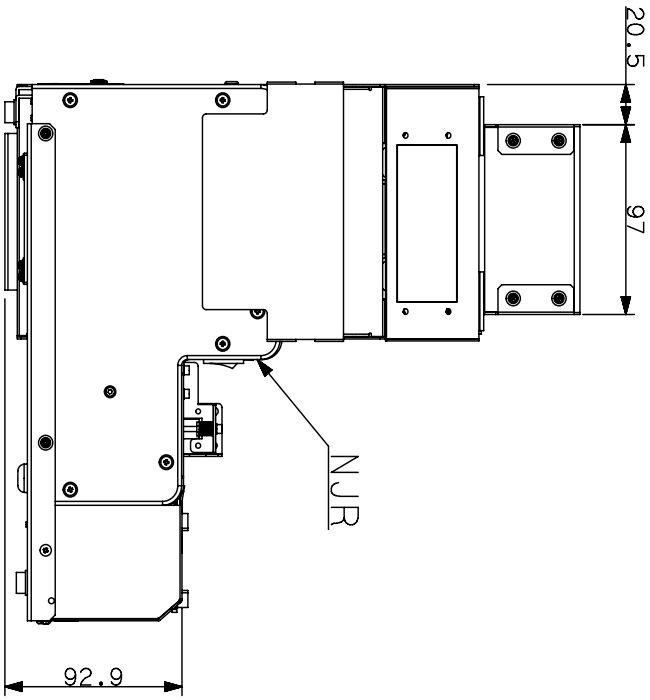
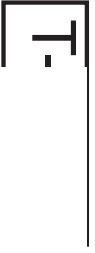

T-510F

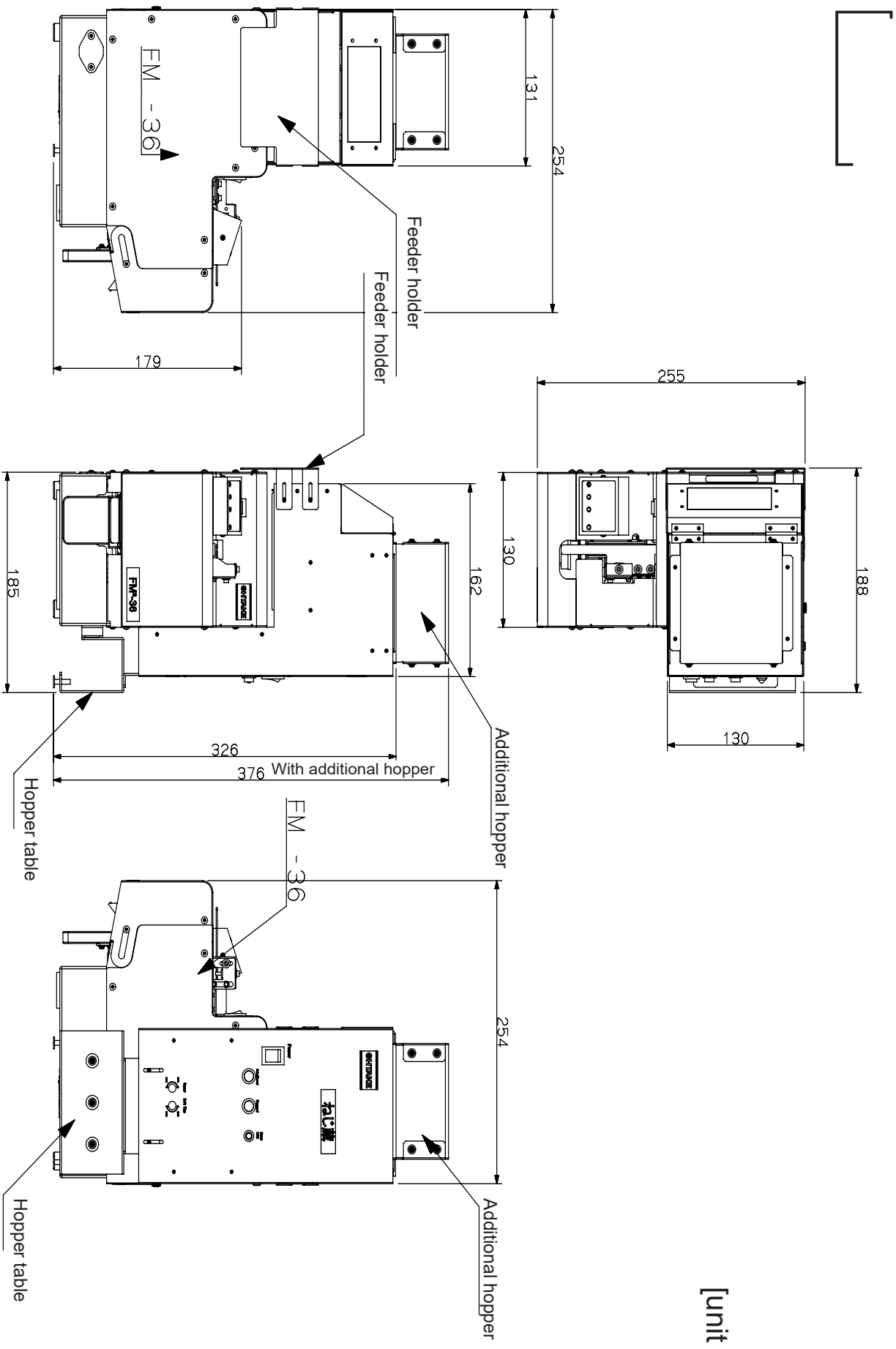

[unit : mm]

## ADDITIONAL REAR HOPPERS



- ▶ Easy installation : just line it up next to the screw dispenser.
- ▶ Suitable for a stock of screws of about 800 cc.
- ▶ Timer dispensing adjustment.

### Compatibility

Model	Suitable dispensers
NJ-80	NJ / NJR
NJ-80F	FM-36 / FME-36
SR-80	NSB / NSR / NSBI / NSRI / NSRI-B

### References

Hoppers	
Model	Code
Rear hopper NJ-80 P/NJ NJR	<b>4-1510299</b>
Rear hopper NJ-80F P/FM-36	<b>4-1510300</b>
Rear hopper SR-80 P/NSB NSR NSBI NSRI	<b>4-1510302</b>

### Features

Model	External dimensions	Screw capacity	Suitable Ø screw body (mm)	External signal line (remaining quantity sensor)
NJ-80	142 x 191 x 188 (H)	ENV 800 CC	M2 to M6	No
NJ-80F				No
SR-80	142 x 191 x 189 to 198 (H)			No

#### NJ-80 and dispenser NJR

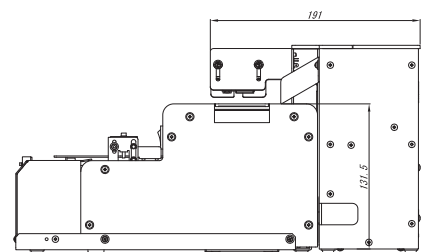
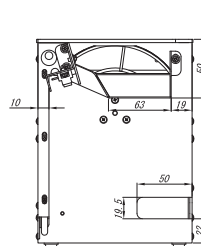
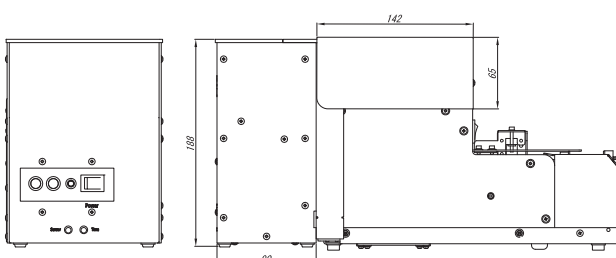
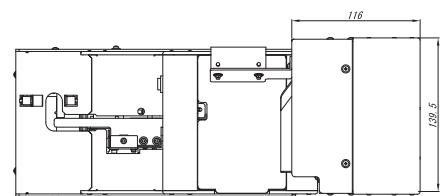
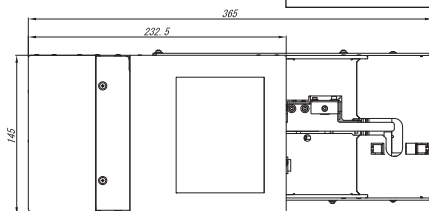

**NJ-80 F and dispenser FM-36**

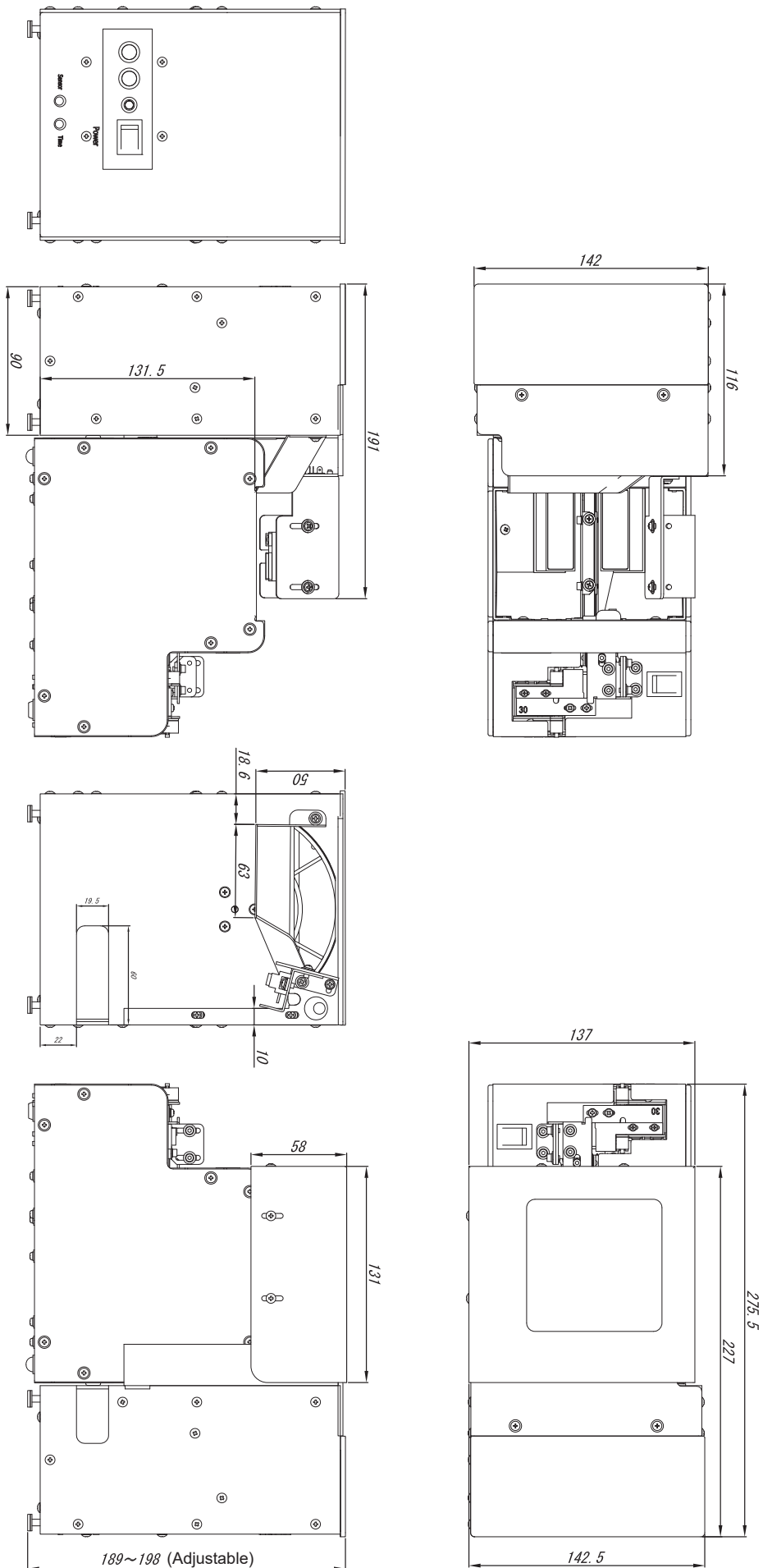

**SR-80 and dispenser NSR**

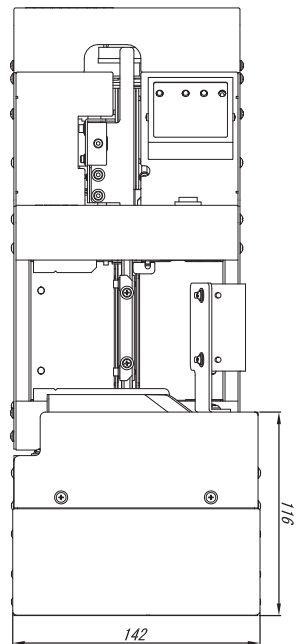
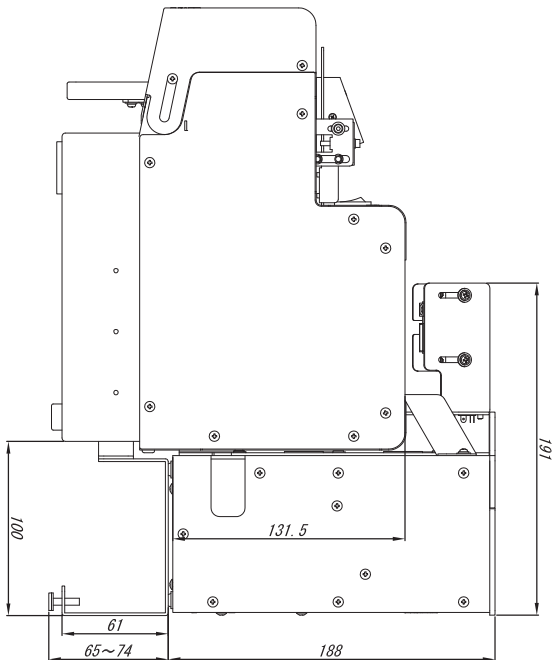
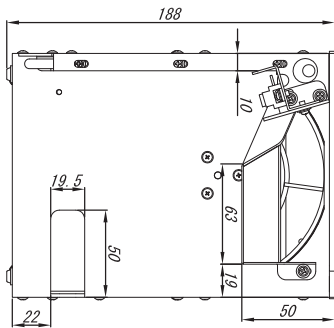
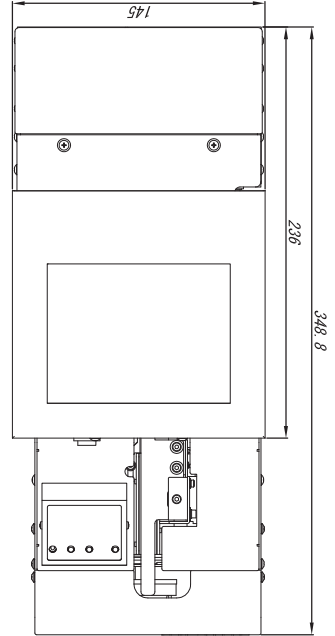
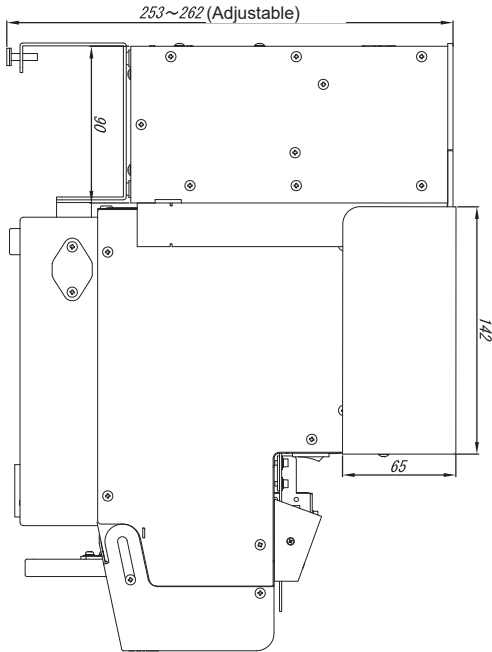
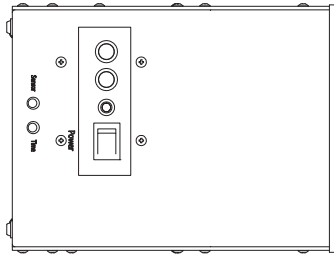



## Assembly sleeve supports and guides on feeder NJR / NSR

Model	Code
Support and guide for sleeve vacuum kit Delvo	<b>4-1525007</b>
Support and guide for sleeve vacuum kit GX30V	<b>4-1525032</b>
Support and guide for sleeve vacuum kit GX40V	<b>4-1525029</b>
Support and guide for sleeve vacuum kit MD26	<b>4-1525030</b>
Support and guide for sleeve vacuum kit MD32	<b>4-1525031</b>

## Assembly and setting packages

Model	Code
Assembly package	<b>4-1525011</b>
Setting package for dispenser adjustment according to screw*	<b>4-1530021</b>

\* For this service a batch of 200 representative screws must be provided to us at the time of the order.

# OUR SERVICES

At DOGA we put at your disposal our reliable, accurate and user friendly tightening solutions. It is our duty to advise you of the right solution for your application.

Our Product Manager and Support engineering teams are here to analyse your manufacturing process and share with you our innovative solutions to improve your assembly process. Thanks to our technical integration service CELPRO, we provide you with turnkey solutions from design to commissioning.



## TURNKEY SOLUTIONS

Using all the options of our complete product range, we offer you solutions adapted to your needs.

- ▶ Custom Design
- ▶ Adaptation of existing models
- ▶ Integration of automation system



## TECHNICAL ASSISTANCE

To ensure the optimal performance and durability of our tools, we put our technical assistance at your disposal.

- ▶ Installation and start-up
- ▶ Maintenance agreement
- ▶ On-site maintenance
- ▶ Maintenance in our workshop



## TRAINING

DOGA offers specialized training courses around its trades:

- ▶ Theoretical
- ▶ Technical & practical
- ▶ Audit & Consulting



# RELATED PRODUCTS



## Assembly tools

By combining the wide range of DOGA industrial screwdrivers and the choices we make together, we will meet your production and quality requirements.

- Torque and angle current control tools
- Torque and angle transducezized control tools - STANLEY®
- Brushless electric tools

> [Learn more about our Assembly tools](#)



## Air vacuum system & sleeves

By holding the screw under vacuum at the end of the screwdriver, this screw gripping system meets your non-magnetic or small screw assembly needs, especially when access to the screw point is restricted..

> [Learn more about air vacuum system & sleeves](#)



Find all our ASSEMBLY TECHNOLOGY products on our website by scanning this QR code



**DOGA**® | ASSEMBLY TECHNOLOGY

✉ international@doga.fr

☎ +33 1 30 66 41 41

📍 8, avenue Gutenberg - CS 50510  
78317 Maurepas Cedex - FRANCE

© DOGA | DOC.60406.08/21

We constantly strive to improve our products. As a result, the dimensions and indications in this document may not always correspond to the latest production. By explicit agreement, our sales are subject to a reservation of title (the provisions of the French 05/12/1980 Act are therefore fully applicable).

[www.dogasassembly.com](http://www.dogasassembly.com)